

## Education Center

5339 Chamblee Dunwoody Rd.  
Atlanta, GA 30338  
770.394.3447

## Gallery & Gift Shop

4681 Ashford Dunwoody Rd.  
Atlanta, GA 30338  
770.394.4019



[www.spruillarts.org](http://www.spruillarts.org)

February 18, 2022

Facilities Authority  
City of Dunwoody  
4800 Ashford Dunwoody Rd  
Dunwoody, GA 30338

The Spruill Center for the Arts is in the second year of a three-year strategic plan that paves a way for our nonprofit to navigate the current pandemic while planning for long-term growth and impact in our community. This first year (2021) demonstrated the effectiveness of this plan, with enrollment figures and earned revenues reaching pre-pandemic levels. At the same time, our organization has increased our community outreach and helped to create numerous pieces of public art at the education center and throughout the city.

At this point in time, we find ourselves in the position of again being out of space to continue to provide the programs that we offer in support of our mission. In 2019, the City of Dunwoody commissioned a study from the Sizemore Group to create a master plan for the Dunwoody Cultural Arts Center. This plan provides room for growth for the various nonprofits that utilize the building, and is predicated on Spruill's financial contribution to fund the expansion. Spruill is now in a financial position to fulfill this obligation.

The current facility stands without much improvements - reflecting its original intent as a municipal school building from the 1960's. At the same time, the City of Dunwoody has made substantial investments with other nonprofits that have resulting in transformational improvements for those organizations; most notable Dunwoody Senior Baseball with the creation of two new playing fields, and the Dunwoody Nature Center with combined investments totaling nearly \$2,000,000 since 2011.

Spruill Center for the Arts is prepared to contribute \$1.3 million towards a \$2.3 million expansion of the Dunwoody Cultural Arts Center and is requesting the Facilities Authority to fund the remaining \$1 million of this project. Complete construction documents have already been created and the project is essentially "shovel ready."

For the purposes of this meeting, Spruill Center for the Arts requests the Facilities Authority's permission to begin our proposed expansion of the kiln room. The cost for this expansion will be financed by Spruill in totality. This expansion is needed to fulfill demand of current program users and will be necessary independent of the remaining facility expansion that has been proposed.

Sincerely,

Alan Mothner  
CEO  
Spruill Center for the Arts

**Education Center**

5339 Chamblee Dunwoody Rd.  
Atlanta, GA 30338  
770.394.3447

**Gallery & Gift Shop**

4681 Ashford Dunwoody Rd.  
Atlanta, GA 30338  
770.394.4019

[www.spruillarts.org](http://www.spruillarts.org)

# Spruill Center for the Arts

## Kiln Room Expansion

## February 28, 2022



## Current Kiln Room and Expansion Area





## Current Kiln Room



# Current Kiln Room

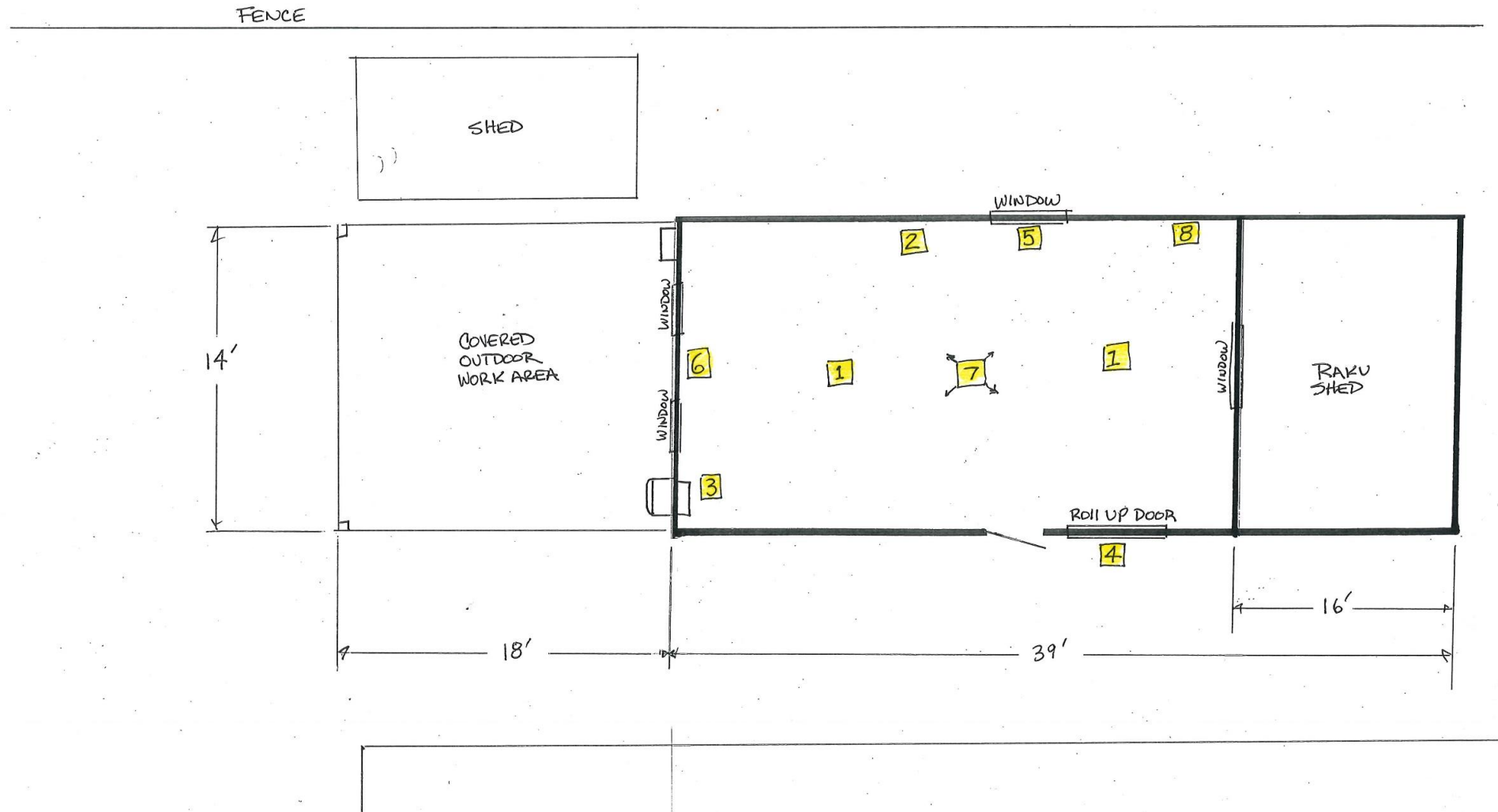



# Current Kiln Room



1. Existing kiln building has 2 ceiling exhaust fans (currently not working). Due to the fact that the existing building will lose all exterior windows, we will require replacement of the two existing ceiling exhaust fans with heat sensors that would clear a room 2800 cfm (?).
2. 4 kiln locations currently have small, unswitched wall electrical connection boxes for the hard wiring of the kilns. Need to replace these with 80-100-amp safety switches when re-routing of the power lines are done. Placement will be approximately in the same location as original boxes.
3. Replace the existing main breaker load center with new updated one.
4. Remove 6' roll up door and re-block closed. Add 36x80" steel doorway in its place.
5. Remove louvered window from back wall and close in opening.
6. Cut out left side block wall, using louvered windows as casing width (aprox. 9 feet wide) and the top of the windows (aprox. 7 feet tall). Header must span the 9 feet without center post. This is the pass thru to the new section. The floor in the new section must be level with the existing kiln building to allow rolling carts to travel back and forth.
7. Scrape and re-paint ceiling. Lighting is fine as is (newer LED).
8. Cut 36x80 doorway with metal door leading to new back end storage.

# Expanded Kiln Room Plan

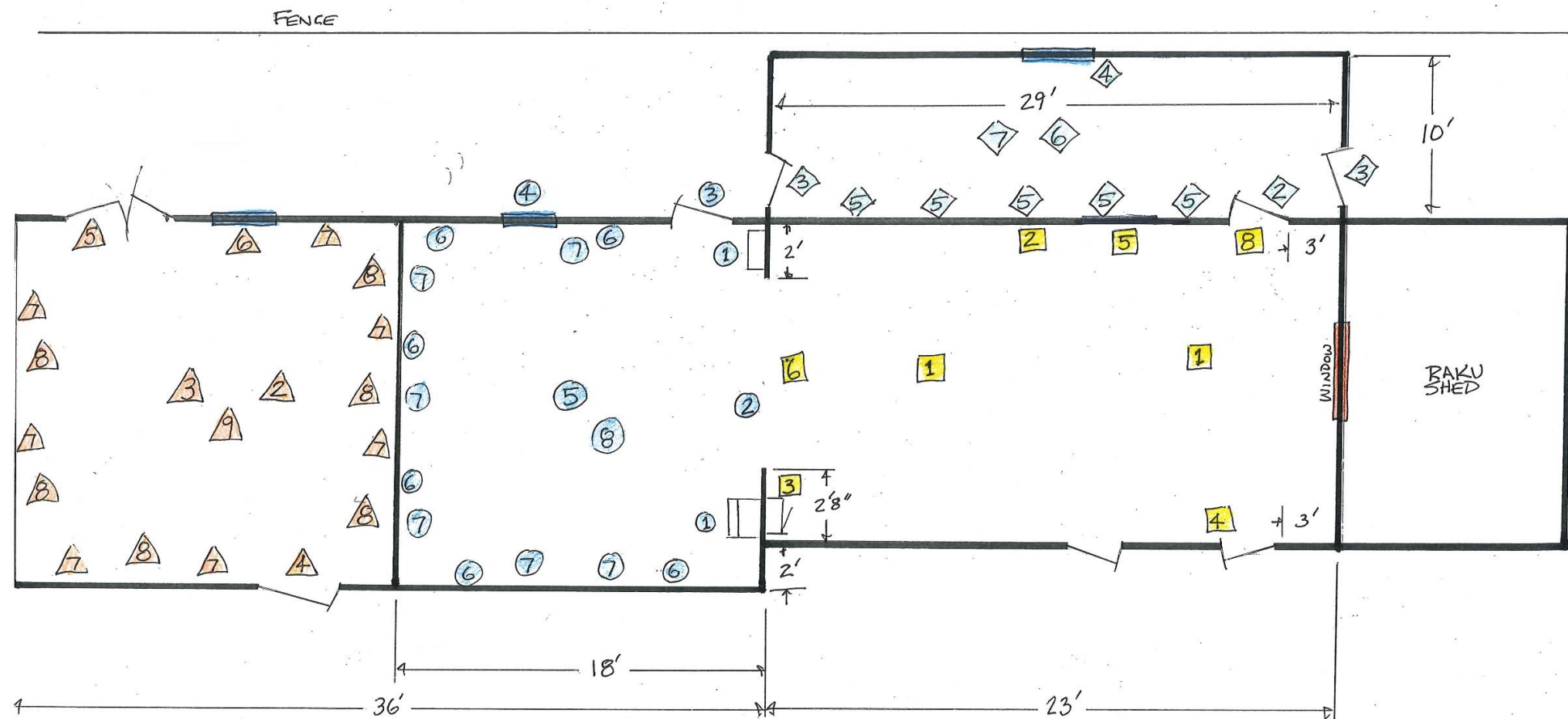



## Expanded Kiln Room Current Use

