

**NOTE:**

REFER TO SHEETS C-01a FOR GENERAL NOTES, LEGENDS AND ABBREVIATIONS. REFER TO EROSION CONTROL NOTES FOR EROSION CONTROL NOTES.

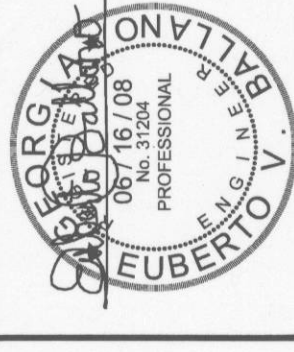

FOR CONSTRUCTION  
 RICHARD WITTSCHIBE  
 HAND  
 ARCHITECTURE INTERIORS PLANNING  
 15009  
 15009  
 15009

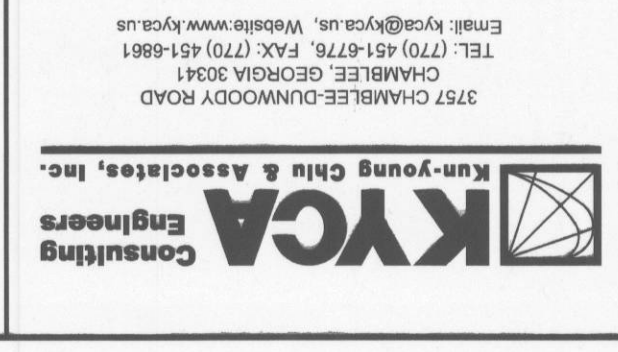

# Dunwoody-Chamblee Area Elementary School 'D' Womack Road

REVISIONS	#	DATE	DESCRIPTION
	1	06-16-08	100% CD

Floor Plans	Site Grading	Final Phase
	1 of 2	
JOB NUMBER	200621	
DATE	6 / 16 / 2008	
SHEET NUMBER		

**C - 06c**

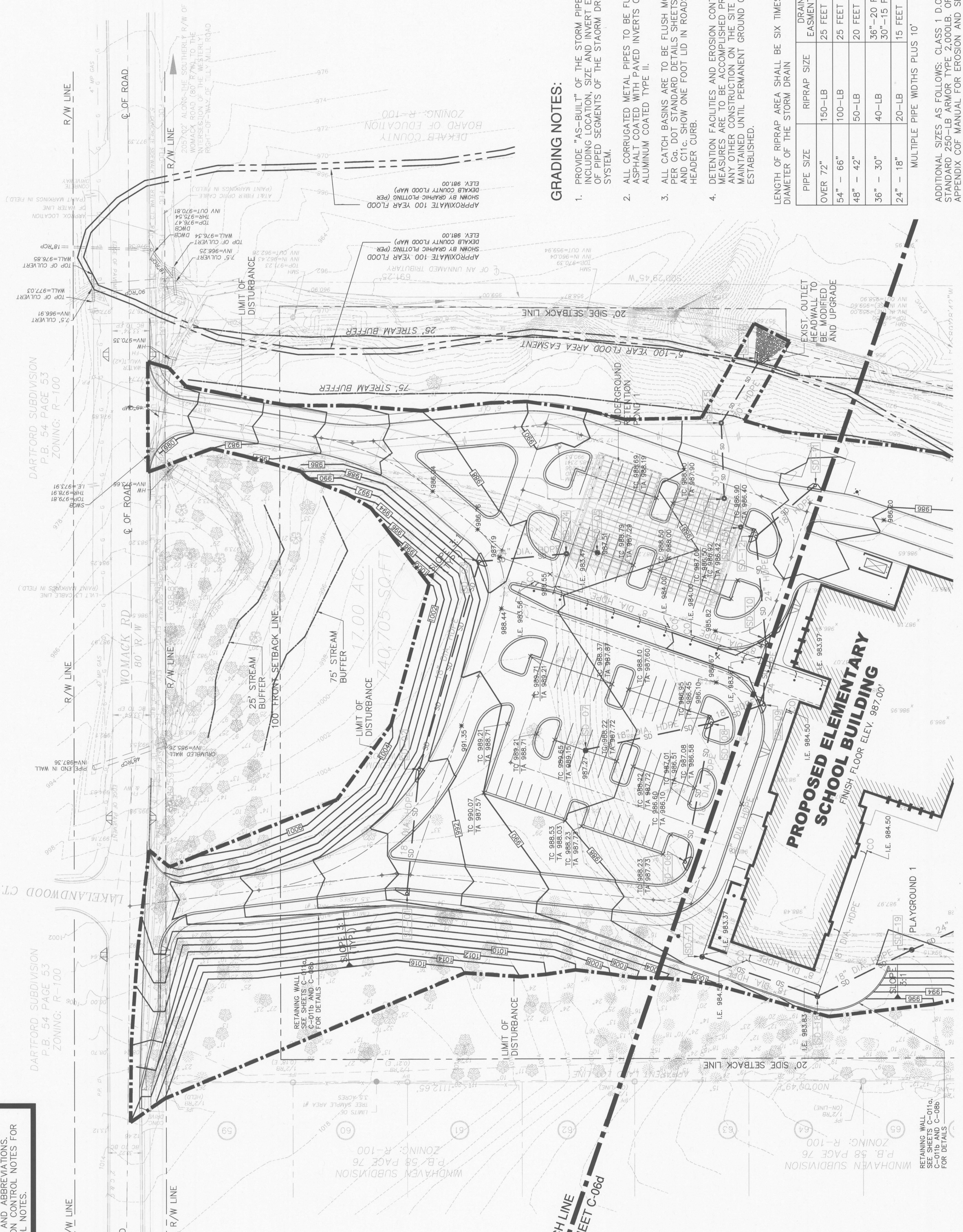

**GRADING NOTES:**

1. PROVIDE "AS-BUILT" OF THE STORM PIPE SYSTEM, INCLUDING LOCATION, SIZE AND INVERT ELEVATIONS OF PIPED SEGMENTS OF THE STORM DRAINAGE SYSTEM.
2. ALL CORRUGATED METAL PIPES TO BE FULLY ASPHALT COATED WITH PAVED INVERTS OR ALUMINUM COATED TYPE II.
3. ALL CATCH BASINS ARE TO BE FLUSH MOUNTED PER G.O. DOT STANDARD DETAILS SHEETS C-11b AND C-11c. SHOW ONE FOOT LID IN ROADS WITH HEADER CURB.
4. DETENTION FACILITIES AND EROSION CONTROL MEASURES ARE TO BE ACCOMPLISHED PRIOR TO ANY OTHER CONSTRUCTION ON THE SITE AND MAINTAINED UNTIL PERMANENT GROUND COVER IS ESTABLISHED.

LENGTH OF RIPRAP AREA SHALL BE SIX TIMES THE DIAMETER OF THE STORM DRAIN

PIPE SIZE	RIPRAP SIZE	DRAINAGE EASEMENT WIDTH
OVER 72"	150-LB	25 FEET
54" - 66"	100-LB	25 FEET
48" - 42"	50-LB	20 FEET
36" - 30"	40-LB	36" - 20 FEET, 30" - 15 FEET
24" - 18"	20-LB	15 FEET

MULTIPLE PIPE WIDTHS PLUS 10'

ADDITIONAL SIZES AS FOLLOWS: CLASS 1 D.O.T. STANDARD 250-LB ARMOR TYPE 2,000LB; OR PER APPENDIX C OF MANUAL FOR EROSION AND SEDIMENT CONTROL IN GEORGIA.

**UNDERGROUND RETENTION POND 1:**

DRAINAGE AREA = 4.50 AC.  
 100 YEAR STORAGE  
 VOL = 50,530 CU. FT.  
 100 YEAR ELEV. = 987.07 FT.  
 DISCHARGE = 14.42 CFS

**IF YOU DIG**

IF YOU DIG GEORGIA...  
 CALL US FIRST!  
 1-800-282-7411



GRAPHIC SCALE  
 0 20' 40' 80' 120' 160'

SCALE: 1" = 40'