



4800 Ashford Dunwoody Road
Dunwoody, Georgia 30338
dunwoodyga.gov | 678.382.6700

MEMORANDUM

To: Mayor and City Council

From: Michael Smith, Public Works Director

Date: July 14, 2024

Subject: **Discussion of an Agreement with the Georgia Department of Transportation for Chamblee Dunwoody Road Bridge Enhancements**

ACTION

Discuss final design and cost estimate for enhancements to the Chamblee Dunwoody Road bridge over I-285 to be incorporated into an agreement with the Georgia Department of Transportation (GDOT) as part of the Top End Managed Lanes project.

SUMMARY

The attached graphics include the final design developed based on City Council and GDOT feedback. Since the last presentation to the City Council in December 2024, the fence column LED lighting has been removed at GDOT's direction. GDOT has also directed removal of the barrier wall/planter between the path and the travel lanes. However, that cost is still included in the cost estimate pending further discussion. The negotiated cost of \$2.1 million includes decorative railing, pedestrian lighting, barrier and bridge painting plus a GDOT mandated 50% contingency. The city's 5-year capital budget currently includes \$2,000,000 for this project. The city is expecting to receive a draft intergovernmental agreement from GDOT soon.

DETAILS

The Georgia Department of Transportation (GDOT) is planning to replace the Chamblee Dunwoody Road bridge over I-285 as part of the Top End Managed Lanes project. The new bridge will have the same number of lanes as the existing bridge with a 10-foot sidewalk on the east side of road and a 12-foot-wide shared use path on the west side. With Cotillion Drive and Savoy Drive becoming one-way roads, a return access lane connecting the two roads will also be added to the east side of the bridge.

The planned bridge replacement provides an opportunity for the city to add enhancements to the new bridge which serves as one of the primary gateways into Dunwoody. Kimley-Horn, the design consultant for this project, has continued to refine the initial concepts as shown in the attached presentation based on input from the City Council at meetings in March and April of 2021, June 2022, and September and December of 2024. The design has also been coordinated with the Perimeter Community Improvement District (PCID) to create some continuity with their plans to enhance bridges within the district.

CHAMBLEE DUNWOODY ROAD AND PERIMETER CENTER PARKWAY

AESTHETIC DESIGN GUIDELINES



The Perimeter Bridges Aesthetic Enhancement project was developed in response to the Georgia DOT's I-285 Top End Express Lane Project, which will add express lanes along the northern half of I-285. The project is envisioned as a placemaking initiative for bridges across the district that will reinforce Perimeter as a special and unique place within the Atlanta region.

The DOT's plans call for differing levels of reconstruction and reconfiguration at each bridge location, with some bridges anticipated to receive no alterations. This required a design solution that was flexible enough to be applied to bridges of widely variable ages and conditions while still creating a cohesive aesthetic. The design team developed a "Kit of Parts" approach, which will be folded into the designs for the DOT's MMIP program, as well as applied to bridges outside the MMIP program as separate projects.

This document contains a summary of aesthetic treatments, primarily related to ornamental railings and bridge paint/color finishes.

The design guidelines are intended to be used as a reference in the development of engineering documents for aesthetic enhancements to the Mt. Vernon Highway and Johnson Ferry Road Bridges. It should serve as a written and visual guide for elements that will be added to the bridges as part of MMIP process.

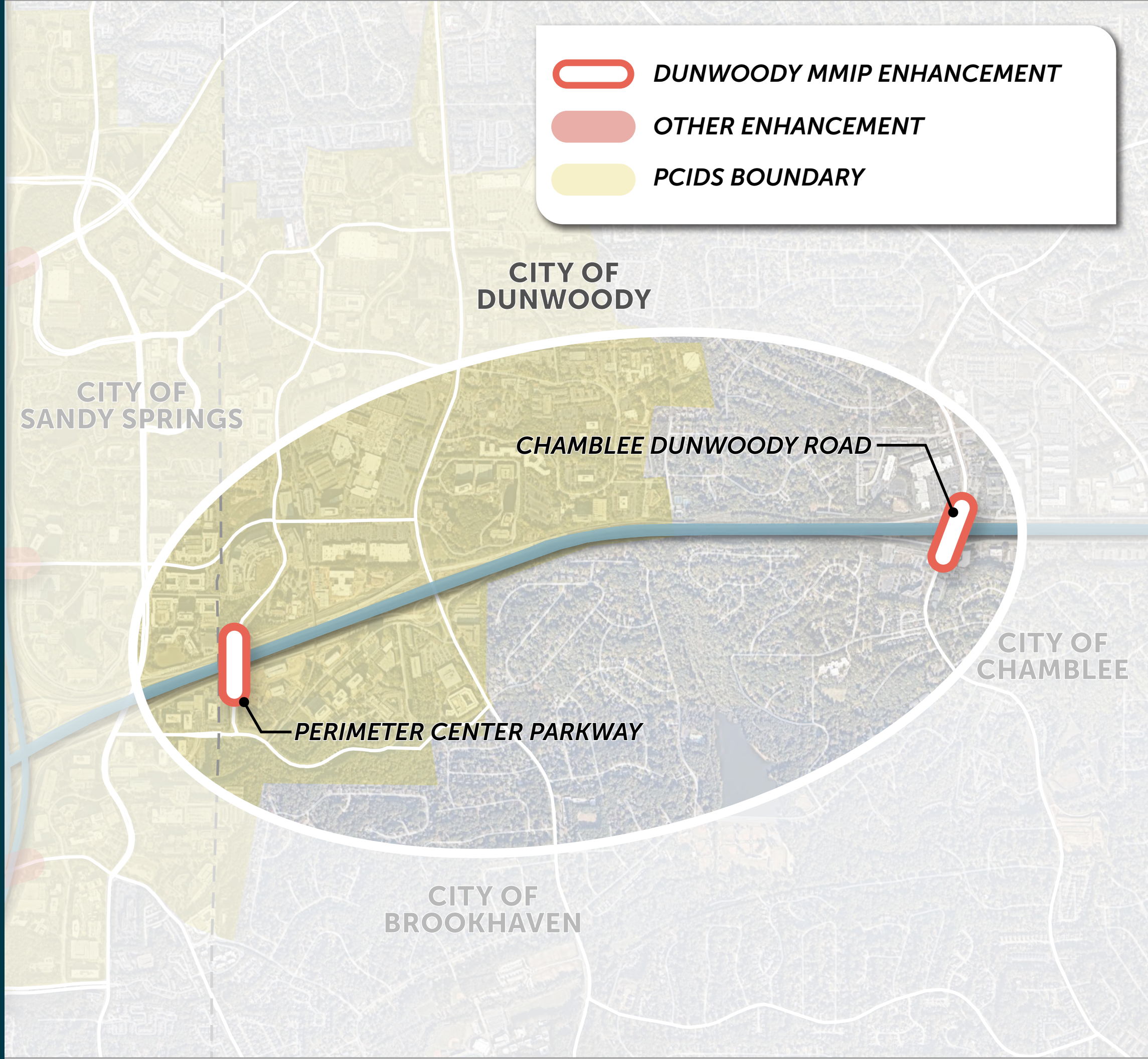

CHAMBLEE - DUNWOODY ROAD



CHAMBLEE - DUNWOODY ROAD



CHAMBLEE - DUNWOODY ROAD

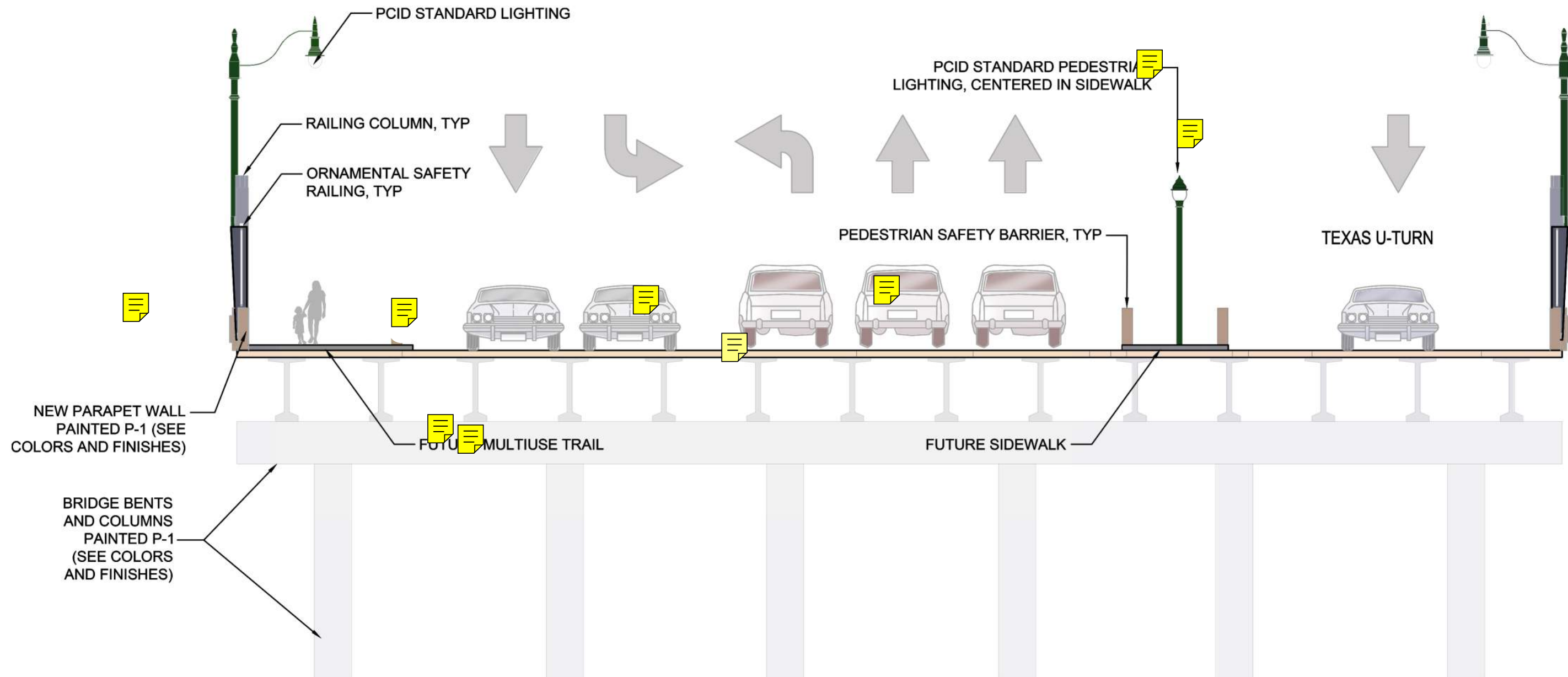

CHAMBLEE - DUNWOODY BRIDGE: SECTION AA

SCALE: 1" = 10'

CHAMBLEE - DUNWOODY ROAD

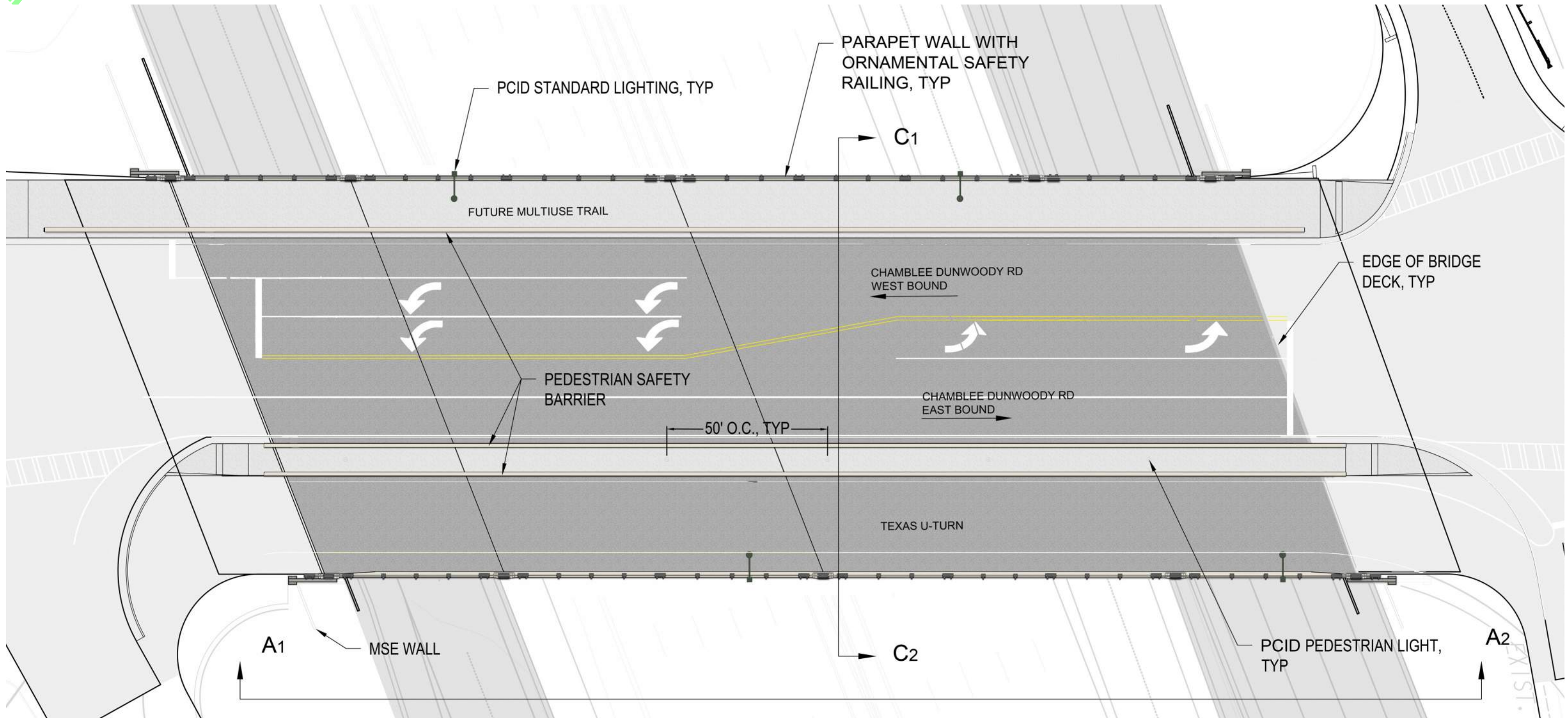

CHAMBLEE - DUNWOODY PLAN VIEW
SCALE: 1" = 30'

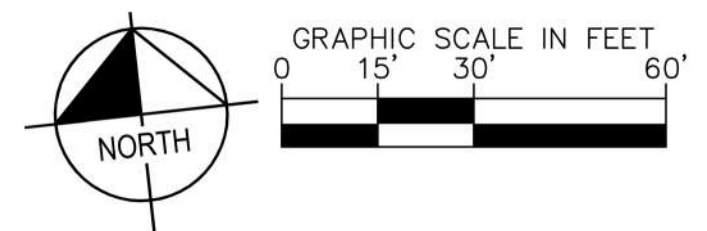

RAILING COLUMN DETAIL



COLUMN RENDERING

NOTES:

- Column to receive Logo Medallion on both side of Bridge, see page 17
- Refer to Color and Finishes Provisions for texture and color requirements

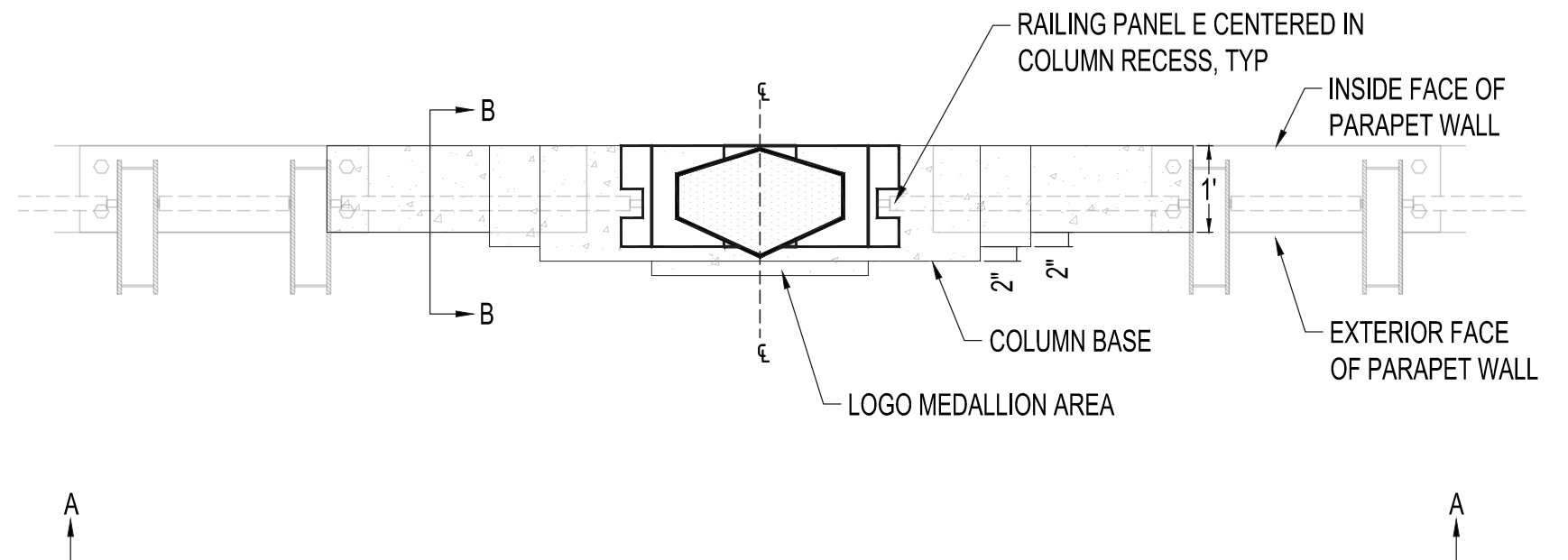

COLUMN PLAN

SCALE: 1/2" = 1'

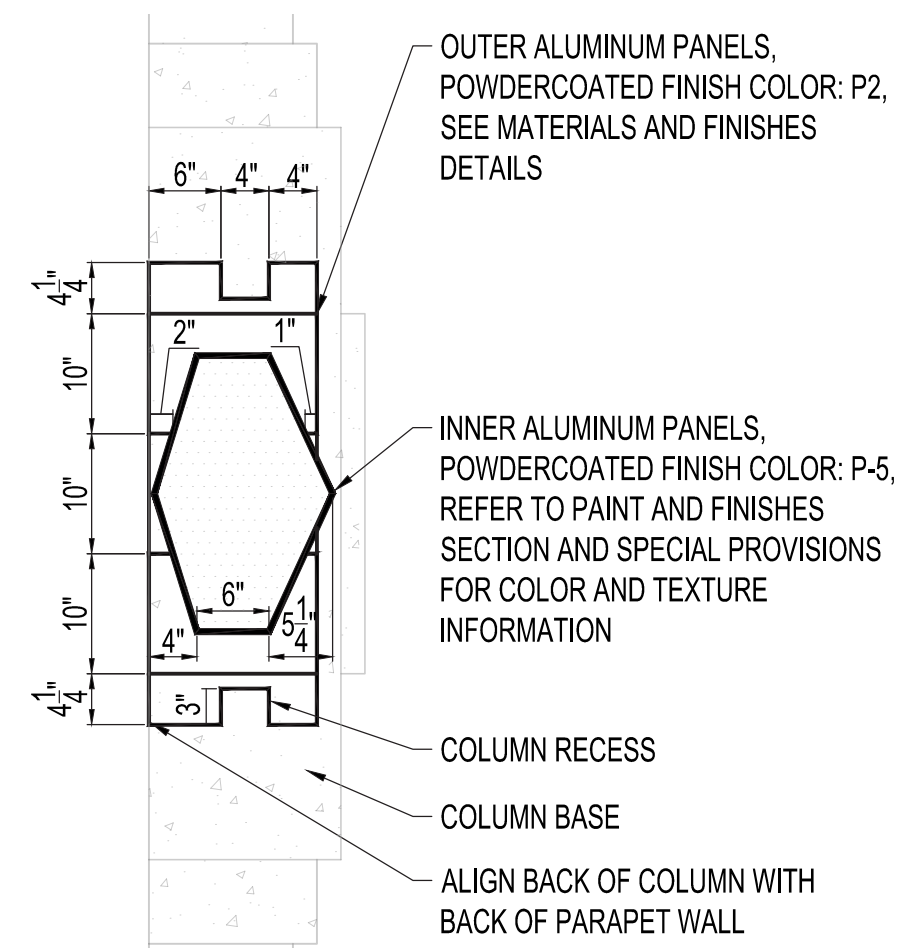

COLUMN DETAILS

SCALE: 3/4" = 1'



END COLUMN DETAIL



END COLUMN RENDERING

NOTES:

- End Column to receive Blank Medallion on both side of Bridge, see pg 17
- Refer to Color and Finishes Provisions for texture and color requirements

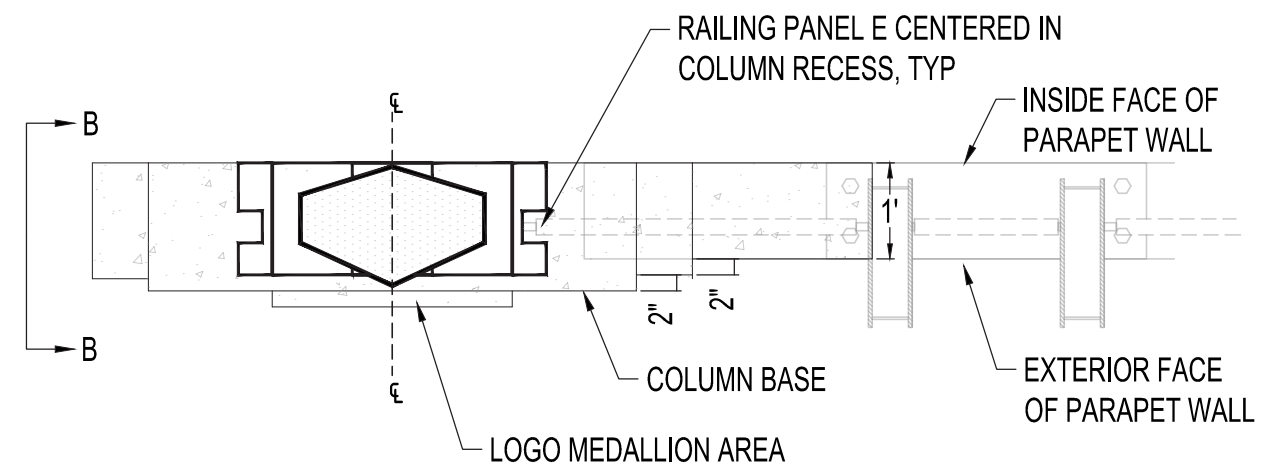

END COLUMN PLAN

SCALE: 3/8" = 1'

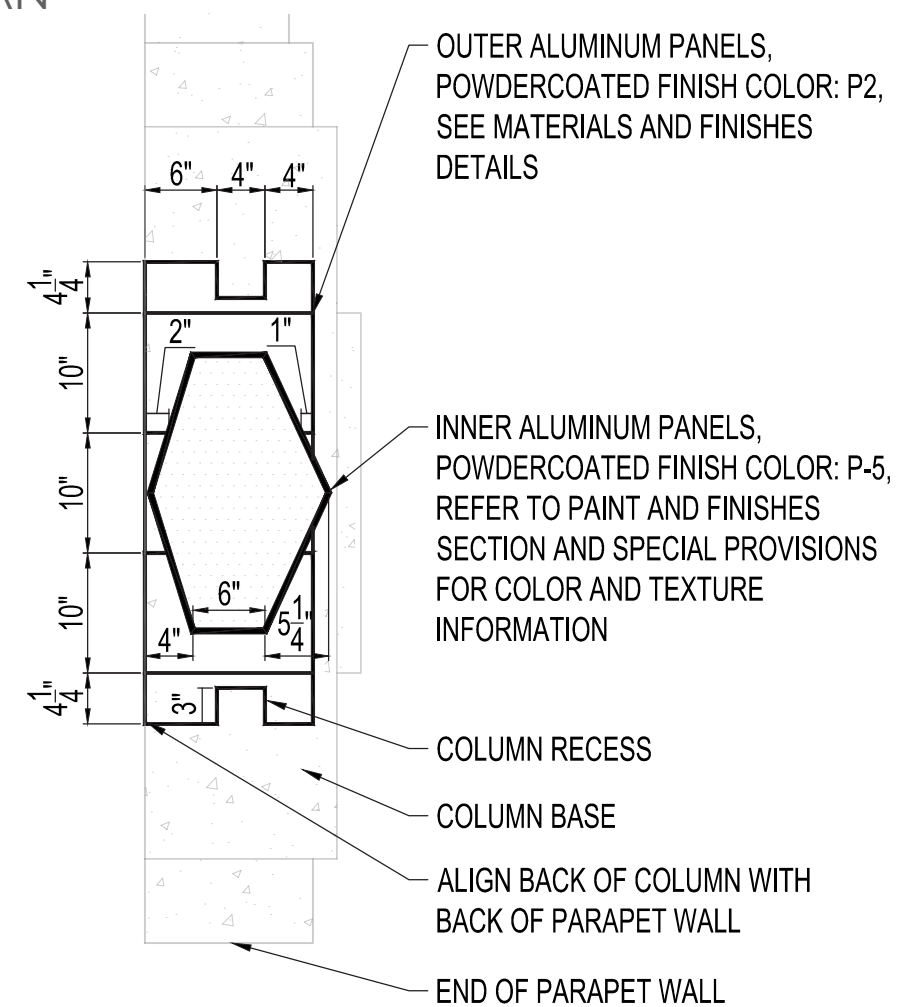

END COLUMN DETAILS

SCALE: 3/8" = 1'



POST AND RAILING DETAILS



FENCE PANEL RENDERING

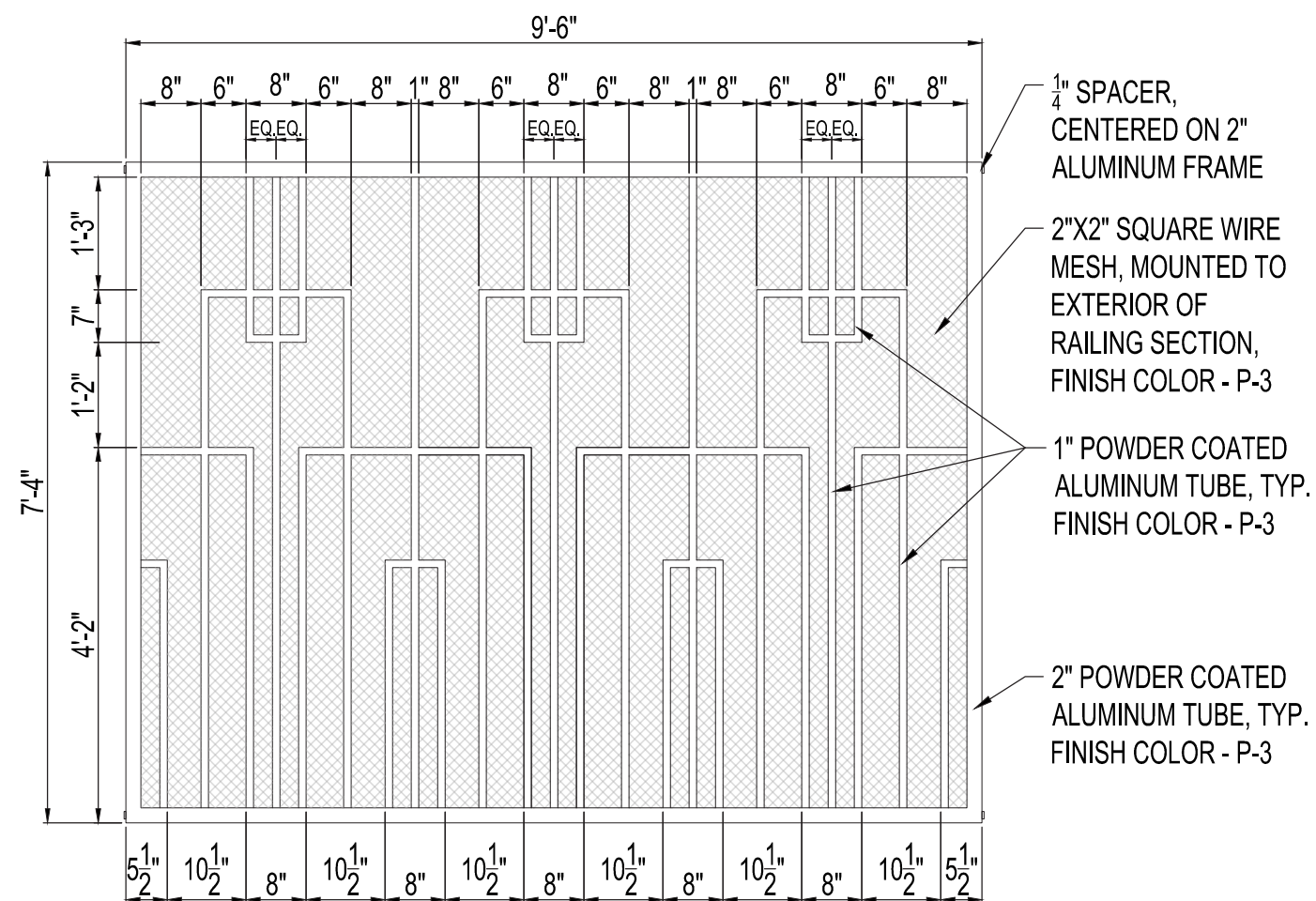

RAILING PANEL A

SCALE: 1/2" = 1'

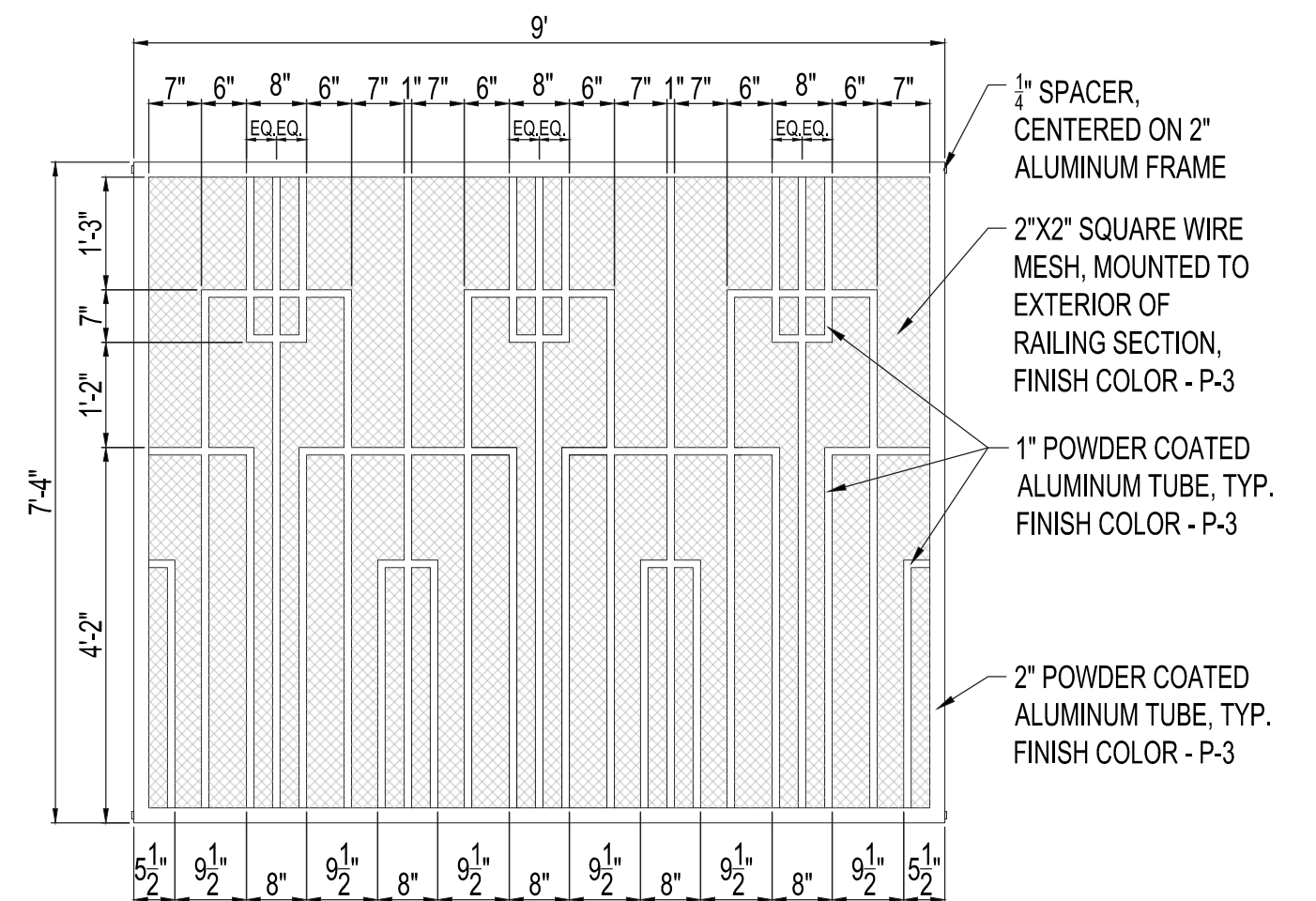

RAILING PANEL B

SCALE: 1/2" = 1'

POST AND RAILING DETAILS



SINGLE POST RAIL RENDERING

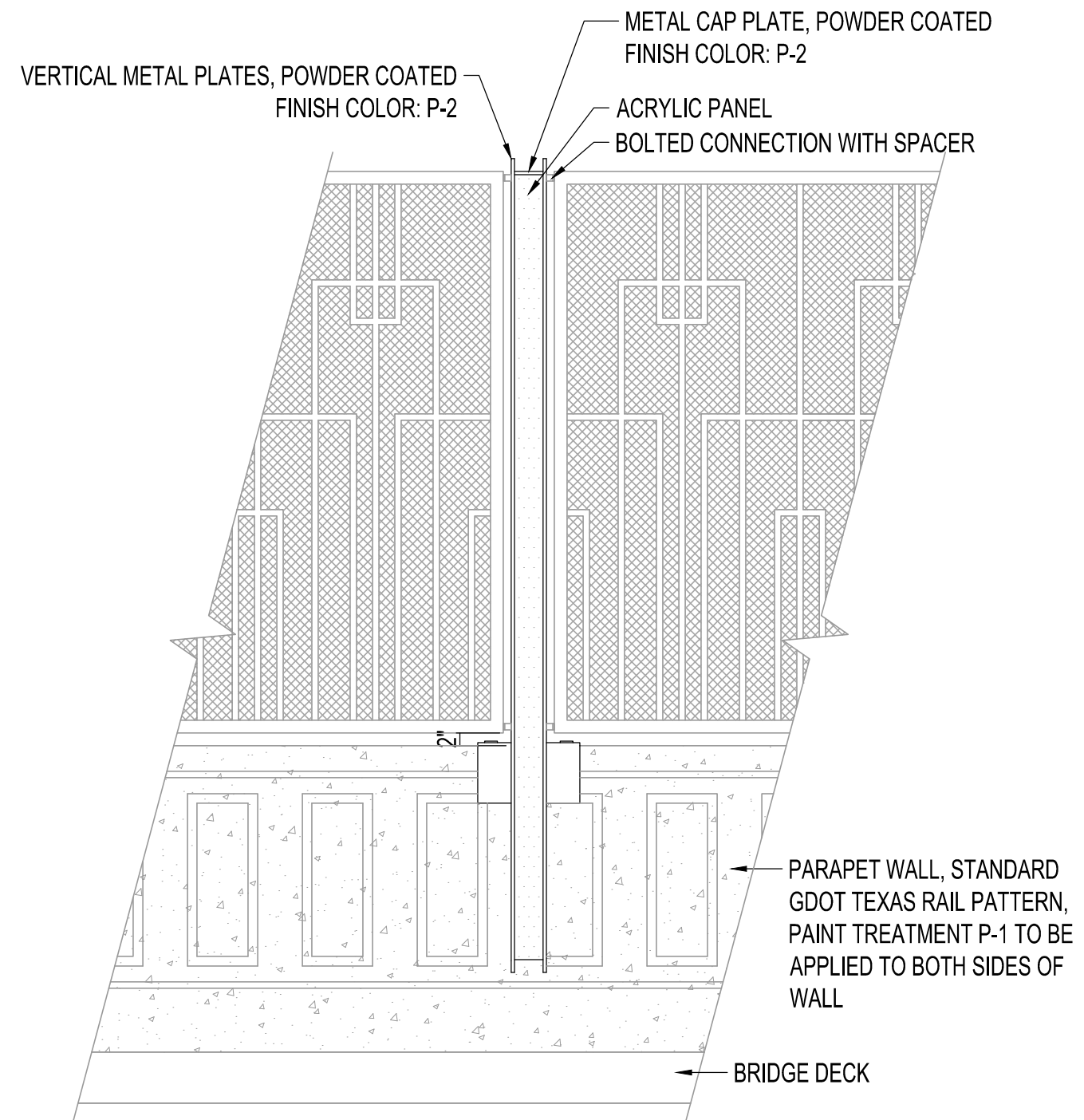

SINGLE POST RAIL ELEVATION

SCALE: 1/2" = 1'



DOUBLE POST RAIL RENDERING

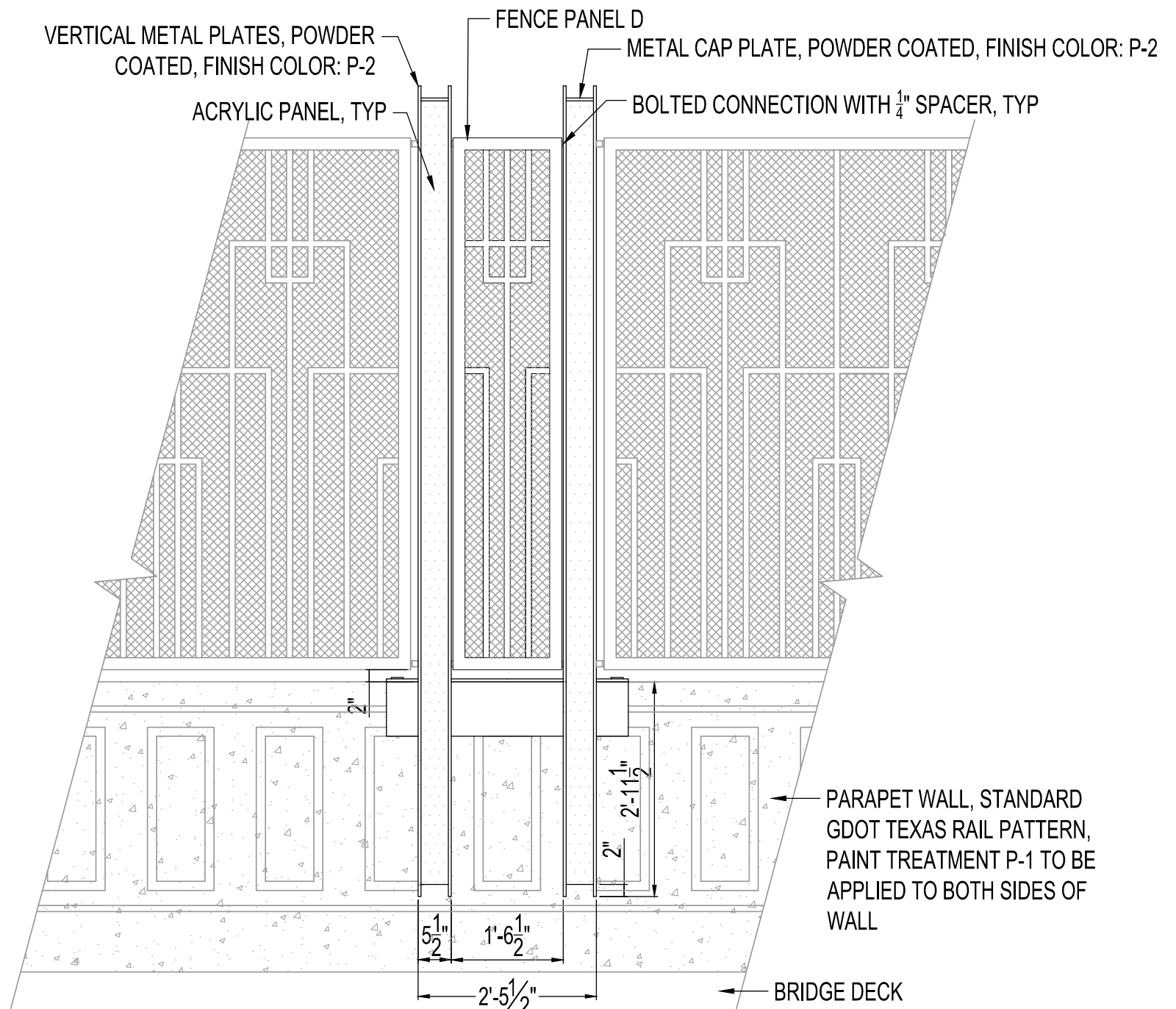

DOUBLE POST RAIL ELEVATION

SCALE: 1/2" = 1'



PERIMETER CENTER PARKWAY

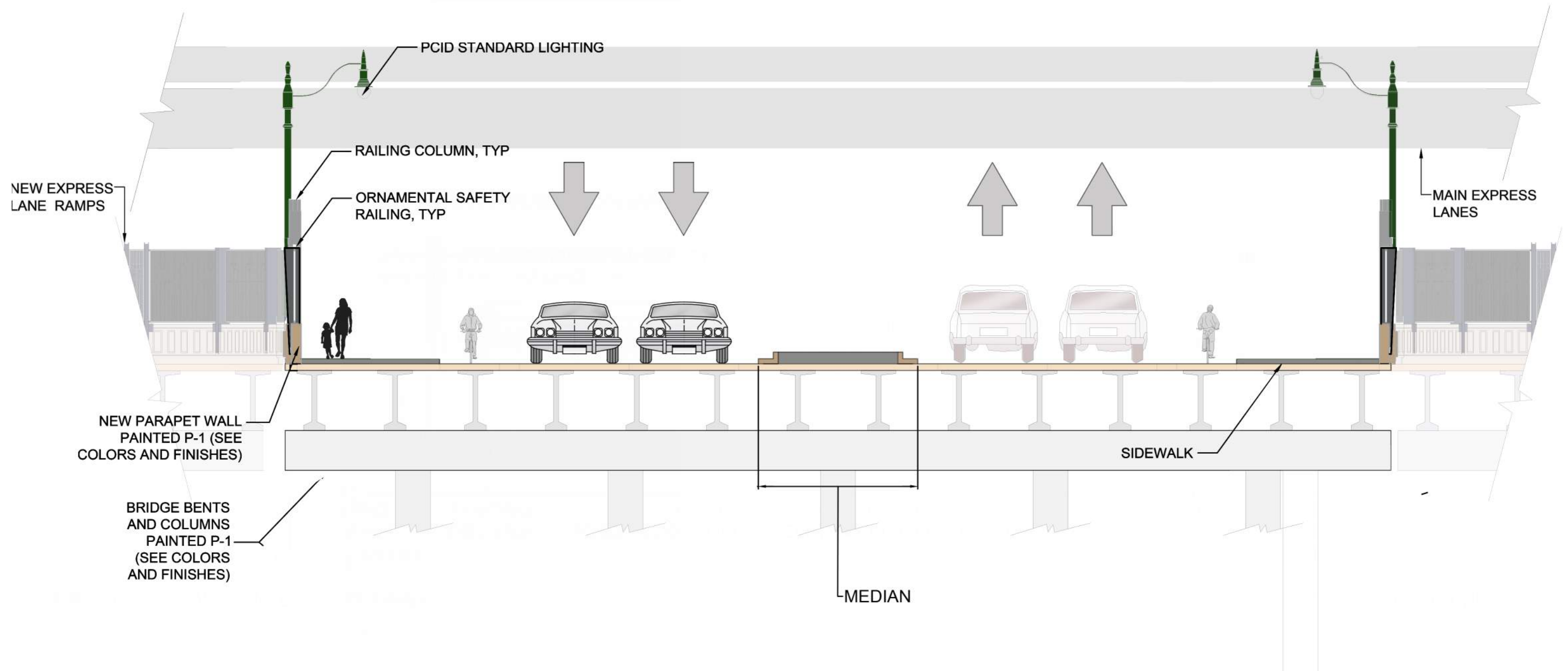

PERIMETER CENTER PARKWAY BRIDGE: SECTION AA



CROSS STREET NAME DETAIL



CROSS STREET NAME SIGN RENDERING

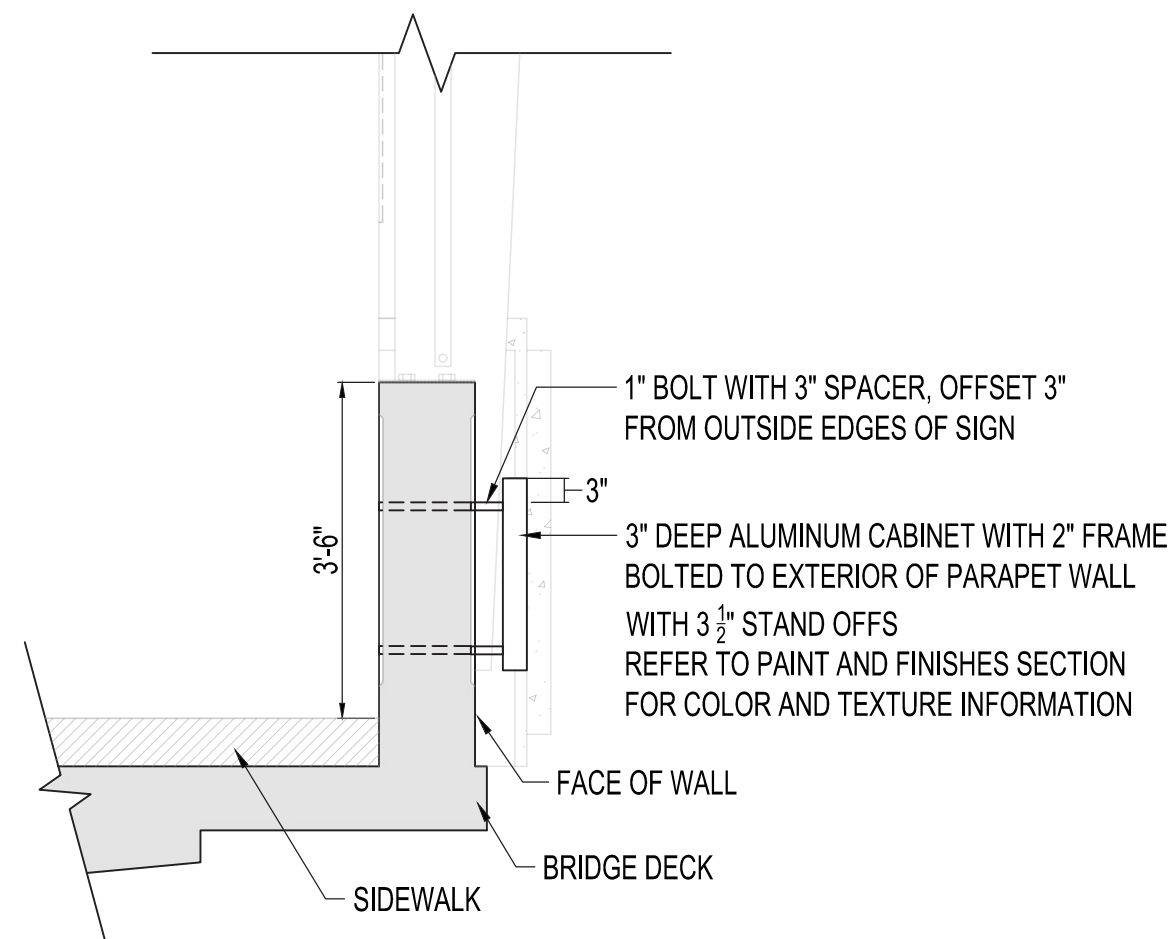

CROSS STREET NAME SIGN SECTION

SCALE: 1/2" = 1'

NOTES AND ASSUMPTIONS

- Cross street names will be bolted-in-place aluminum cabinets with dimensional lettering
- Sign cabinet spacers will provide sufficient clearance from wall to prevent conflicts with railing post locations
- Cross street names will be centered above oncoming travel lines on both sides of bridge (typ.)
- Crossroad names will be centered vertically on the face of the parapet wall
- Type style to match City of Sandy Springs branding requirements
- Letters to be P-7 Dark Blue Logo color, refer to paint and finishes

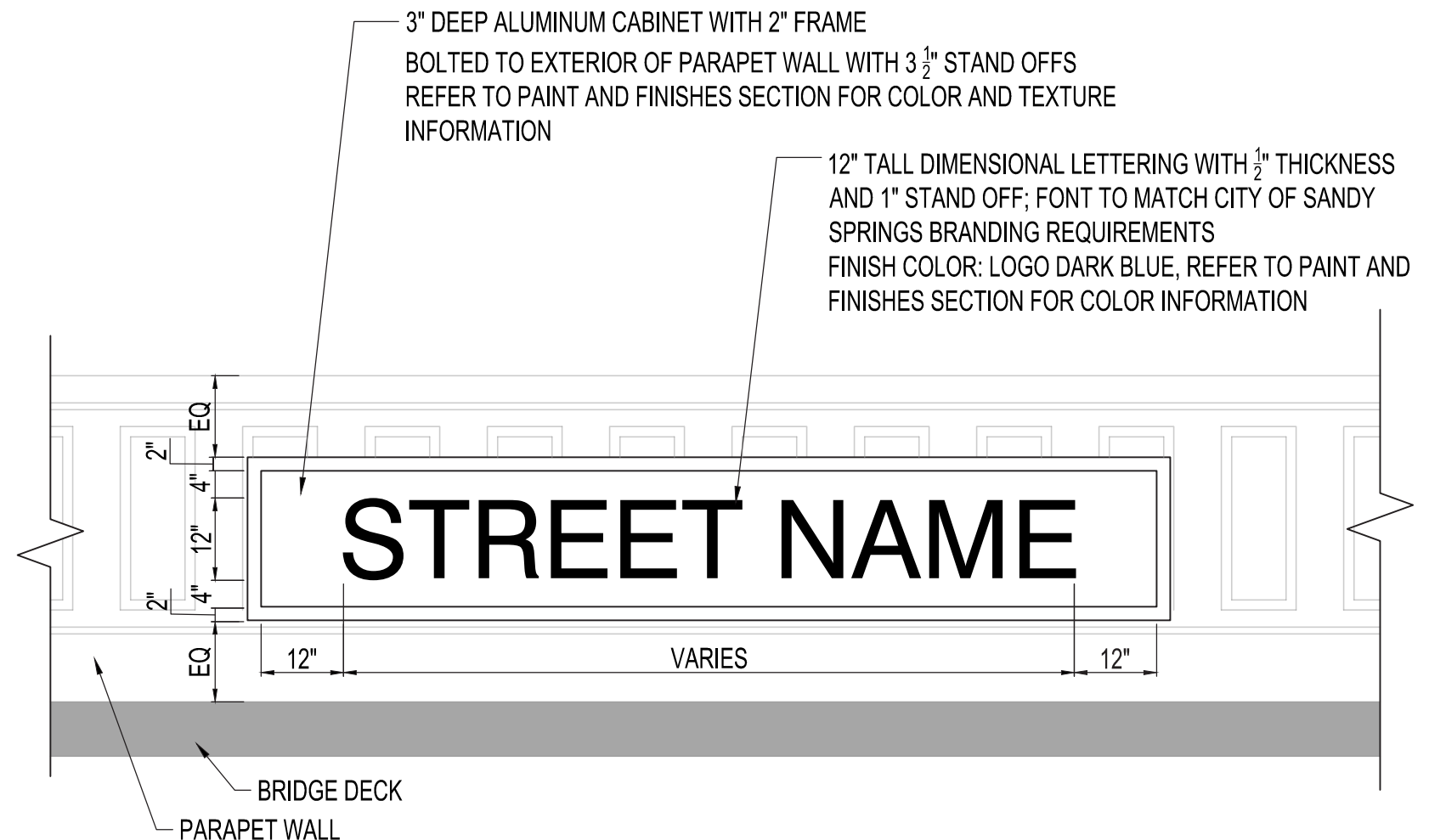

CROSS STREET NAME SIGN DETAILS

SCALE: 1/2" = 1'

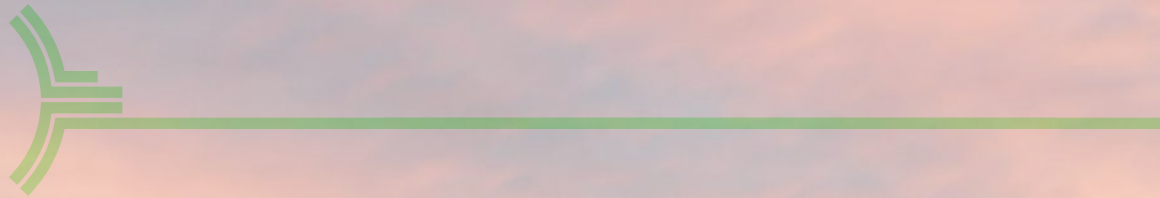

CHAMBLEE DUNWOODY ROAD AND PERIMETER CENTER PARKWAY

AESTHETIC DESIGN GUIDELINES

Kimley»Horn

March 2025



PERIMETER COMMUNITY
IMPROVEMENT DISTRICT

The Perimeter Bridges Aesthetic Enhancement project was developed in response to the Georgia DOT's I-285 Top End Express Lane Project, which will add express lanes along the northern half of I-285. The project is envisioned as a placemaking initiative for bridges across the district that will reinforce Perimeter as a special and unique place within the Atlanta region.

The DOT's plans call for differing levels of reconstruction and reconfiguration at each bridge location, with some bridges anticipated to receive no alterations. This required a design solution that was flexible enough to be applied to bridges of widely variable ages and conditions while still creating a cohesive aesthetic. The design team developed a "Kit of Parts" approach, which will be folded into the designs for the DOT's MMIP program, as well as applied to bridges outside the MMIP program as separate projects.

This document contains a summary of aesthetic treatments, primarily related to ornamental railings and bridge paint/color finishes.

The design guidelines are intended to be used as a reference in the development of engineering documents for aesthetic enhancements to the Mt. Vernon Highway and Johnson Ferry Road Bridges. It should serve as a written and visual guide for elements that will be added to the bridges as part of MMIP process.

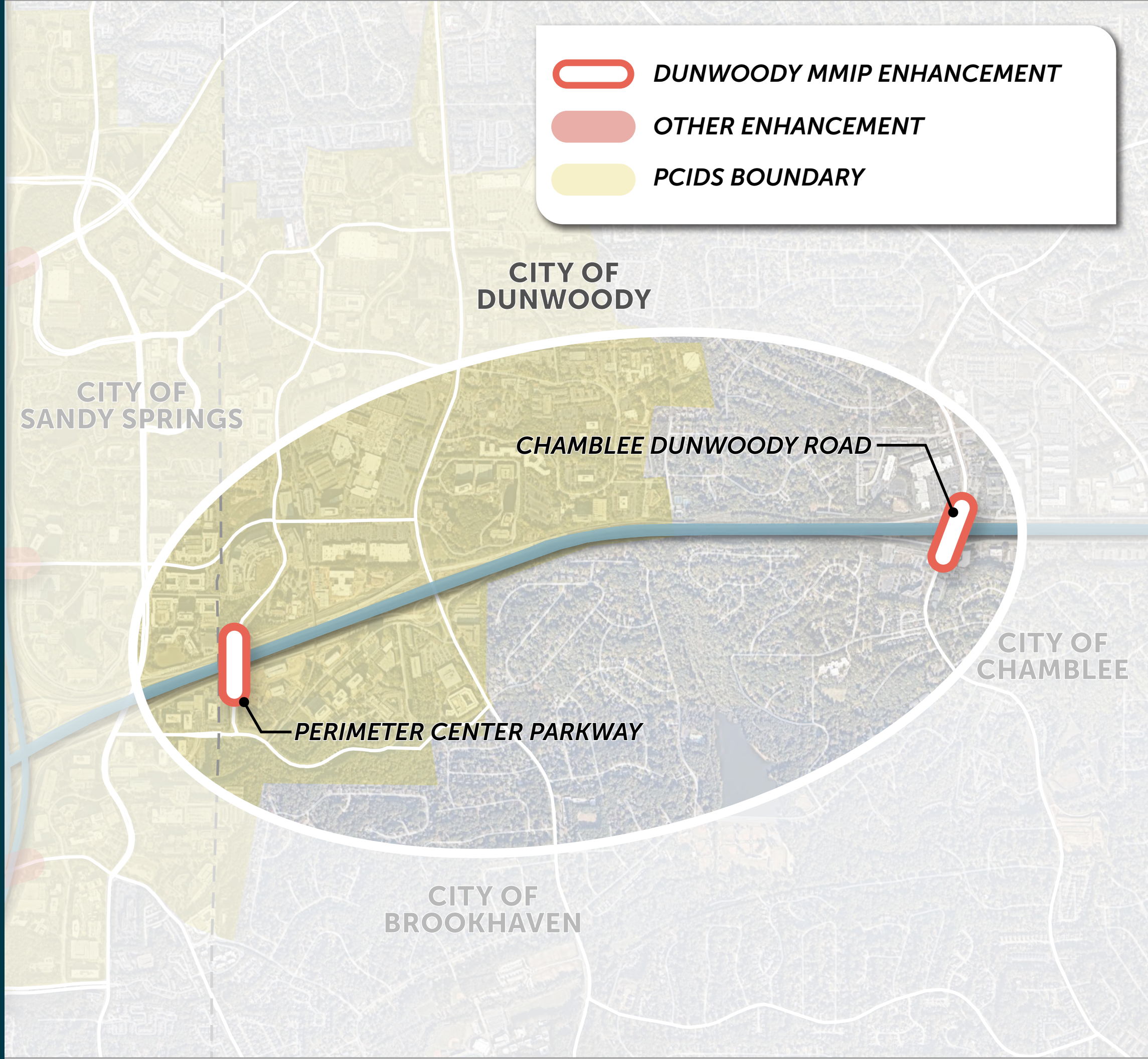

CHAMBLEE - DUNWOODY ROAD



CHAMBLEE - DUNWOODY ROAD



CHAMBLEE - DUNWOODY ROAD

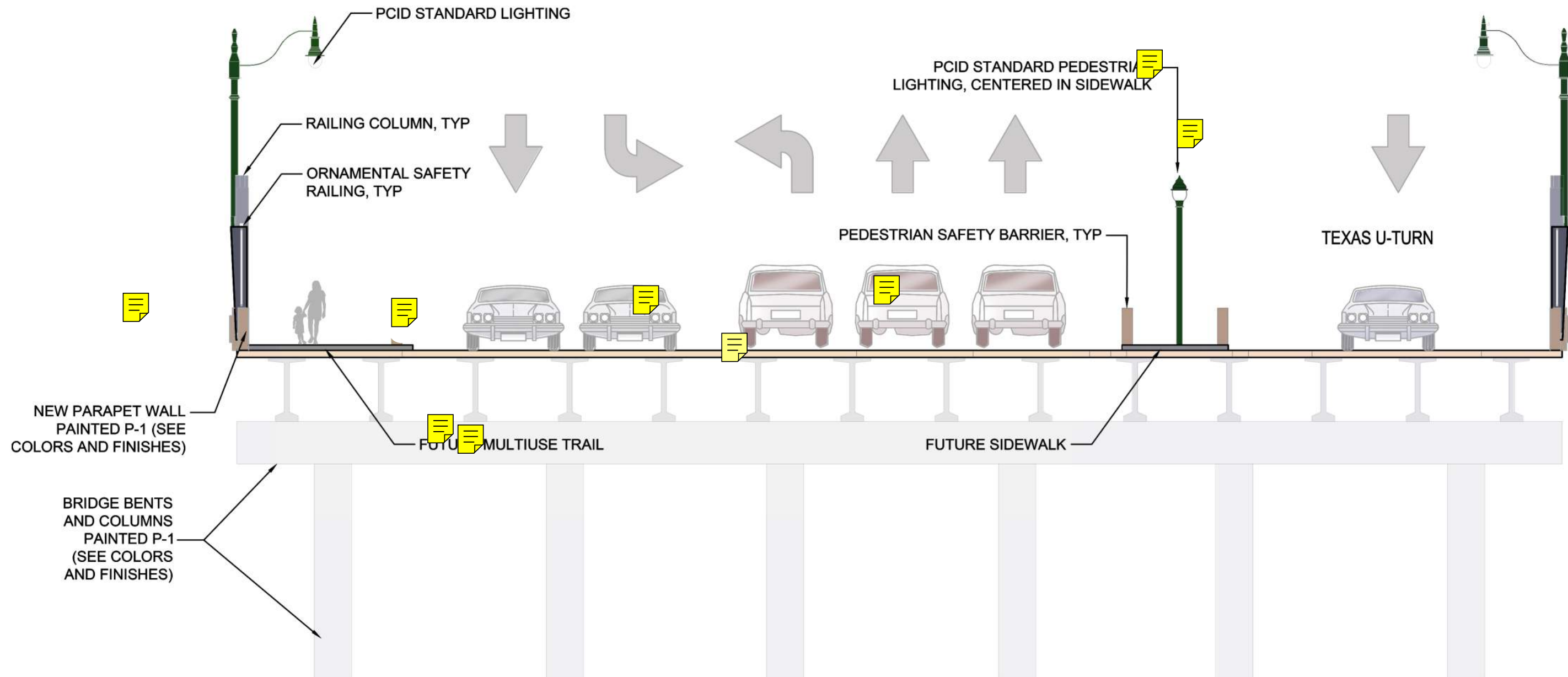

CHAMBLEE - DUNWOODY BRIDGE: SECTION AA

SCALE: 1" = 10'

CHAMBLEE - DUNWOODY ROAD

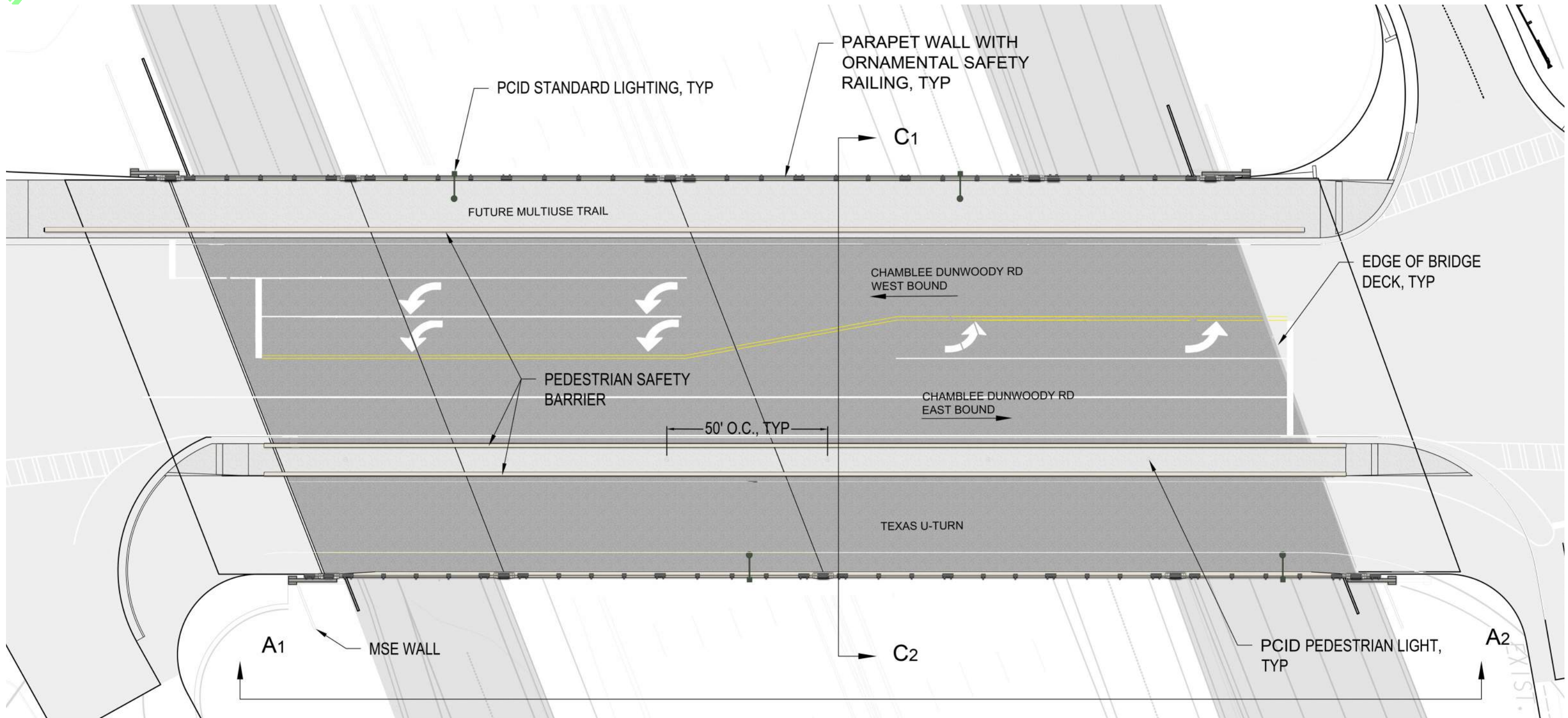

CHAMBLEE - DUNWOODY PLAN VIEW
SCALE: 1" = 30'

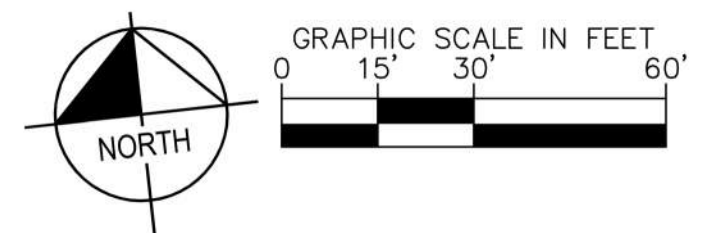

RAILING COLUMN DETAIL



COLUMN RENDERING

NOTES:

- Column to receive Logo Medallion on both side of Bridge, see page 17
- Refer to Color and Finishes Provisions for texture and color requirements

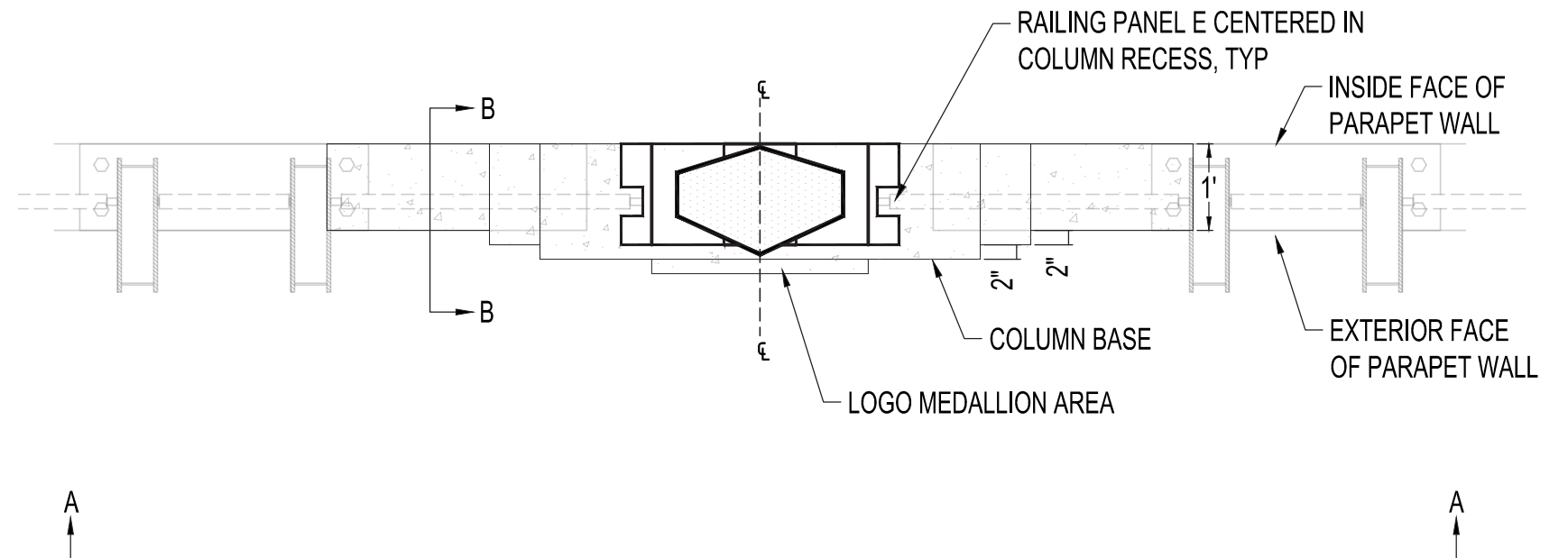

COLUMN PLAN

SCALE: 1/2" = 1'

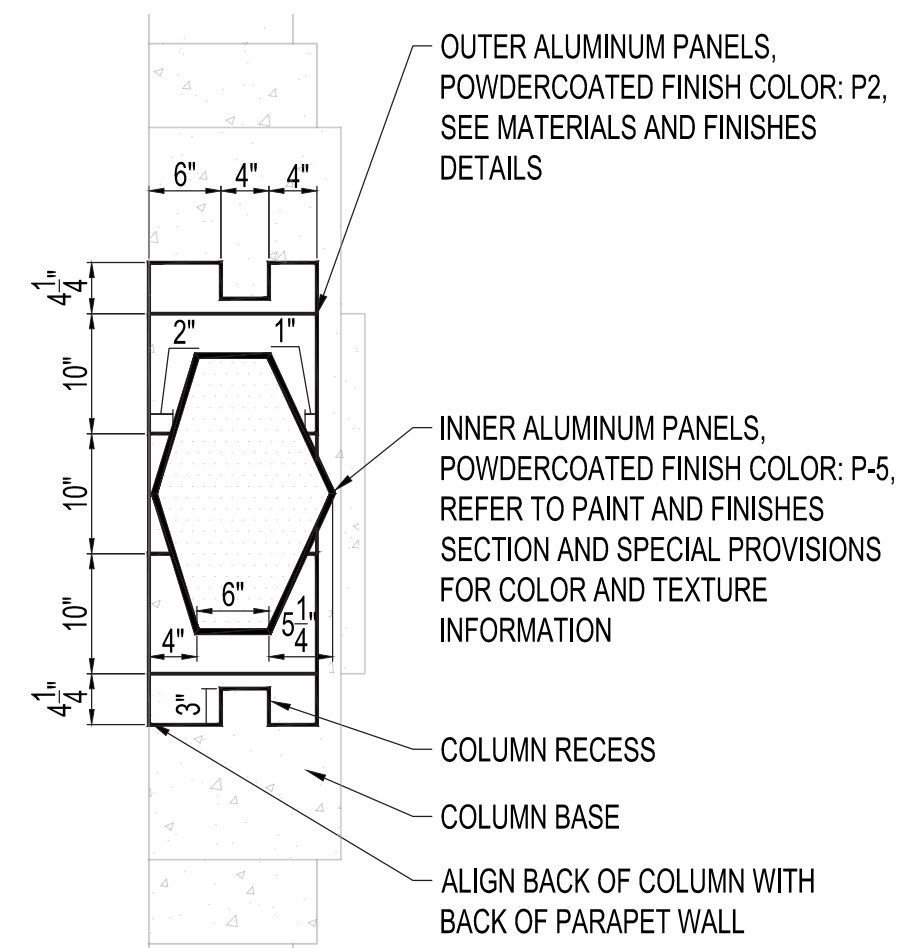

COLUMN DETAILS

SCALE: 3/4" = 1'



END COLUMN DETAIL



END COLUMN RENDERING

NOTES:

- End Column to receive Blank Medallion on both side of Bridge, see pg 17
- Refer to Color and Finishes Provisions for texture and color requirements

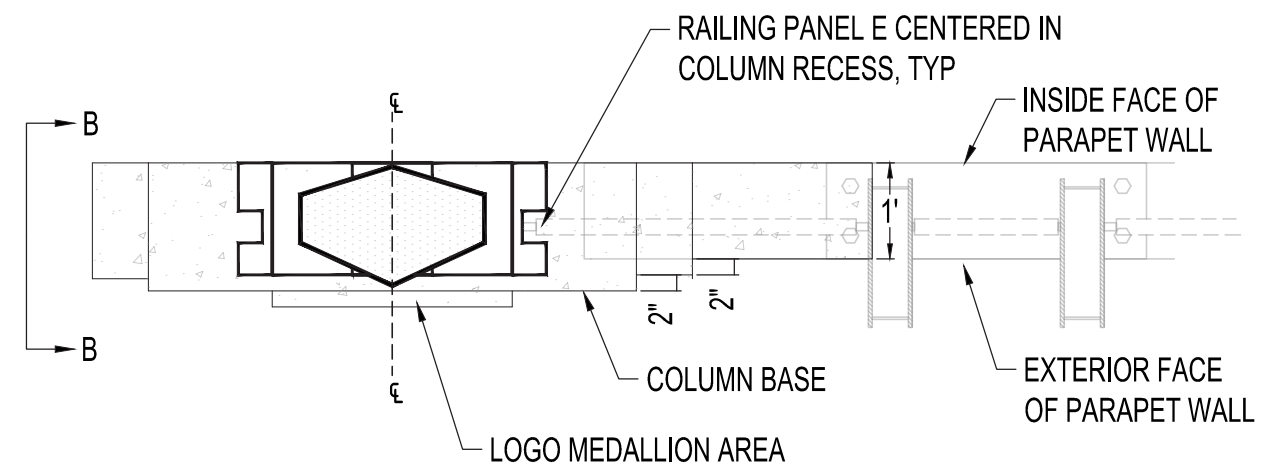

END COLUMN PLAN

SCALE: 3/8" = 1'

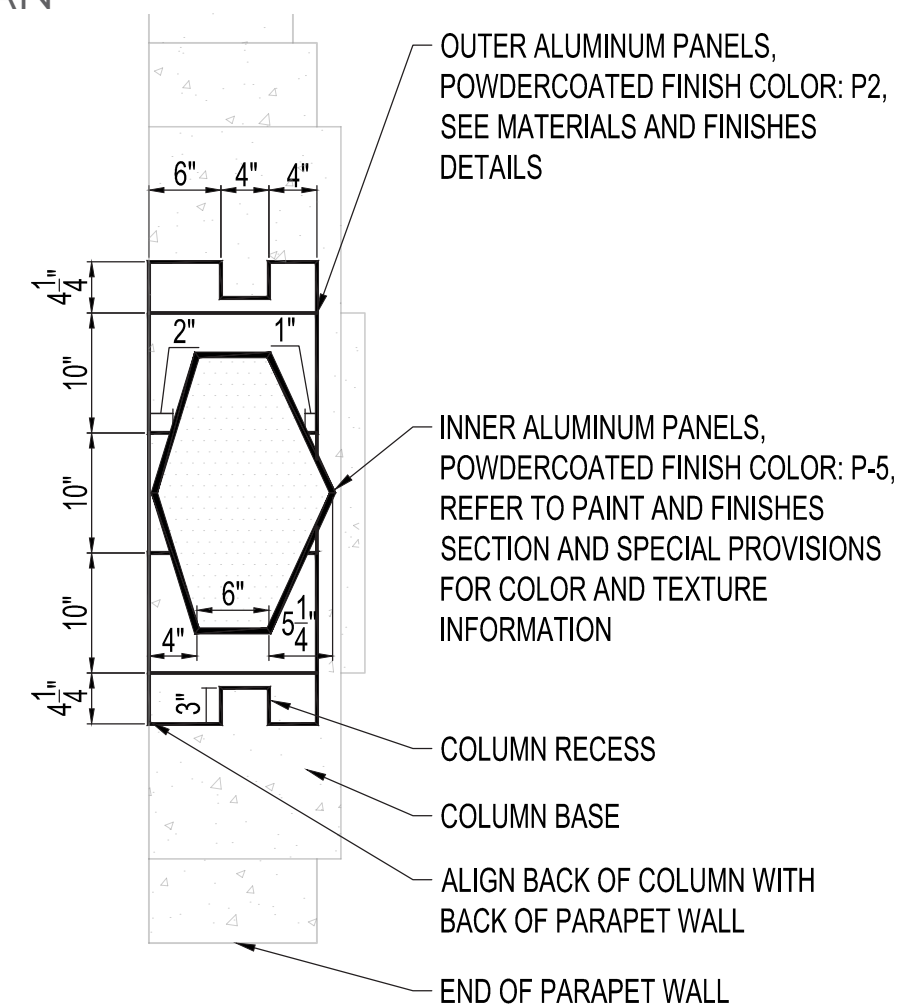

END COLUMN DETAILS

SCALE: 3/8" = 1'



POST AND RAILING DETAILS



FENCE PANEL RENDERING

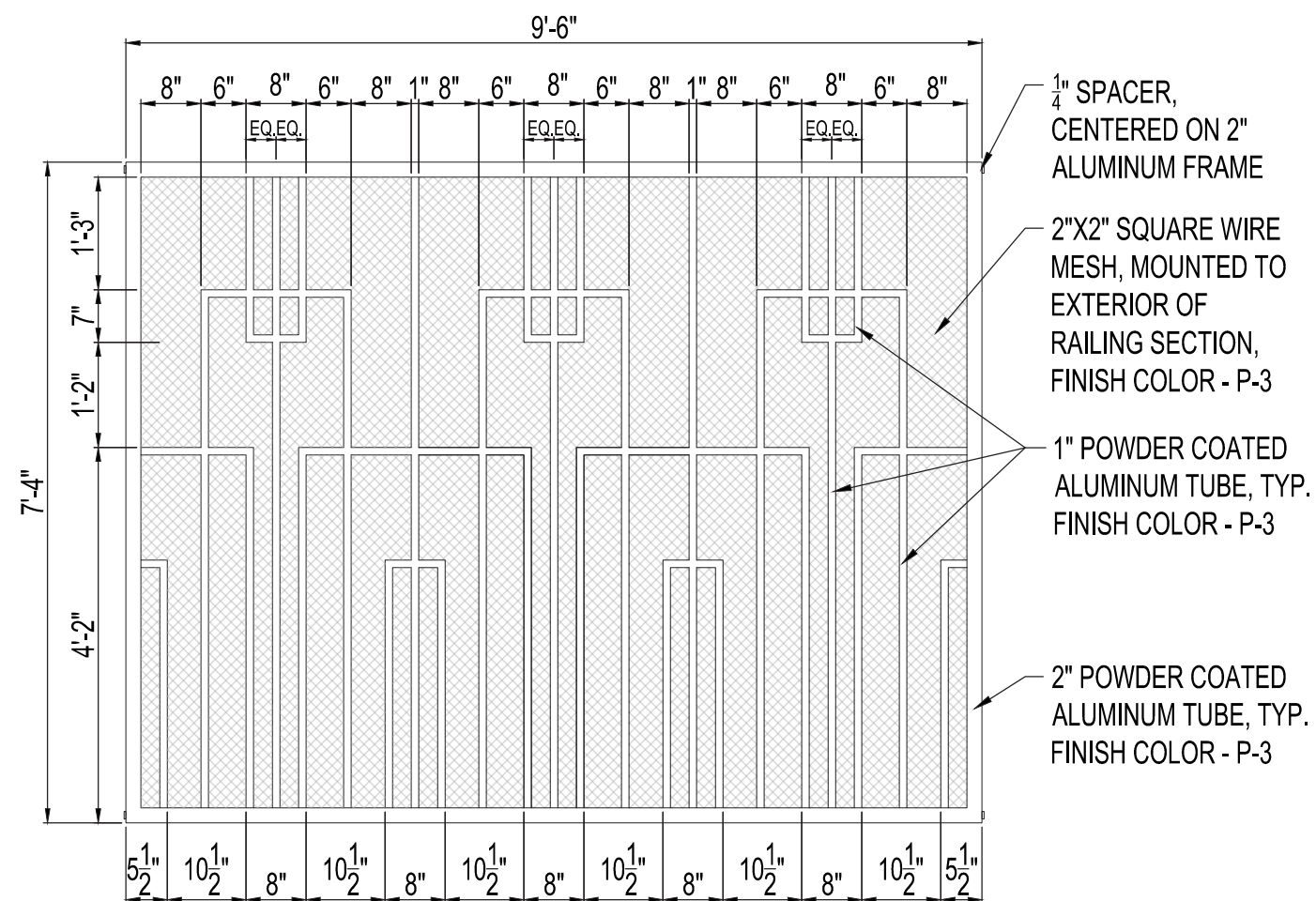

RAILING PANEL A

SCALE: 1/2" = 1'

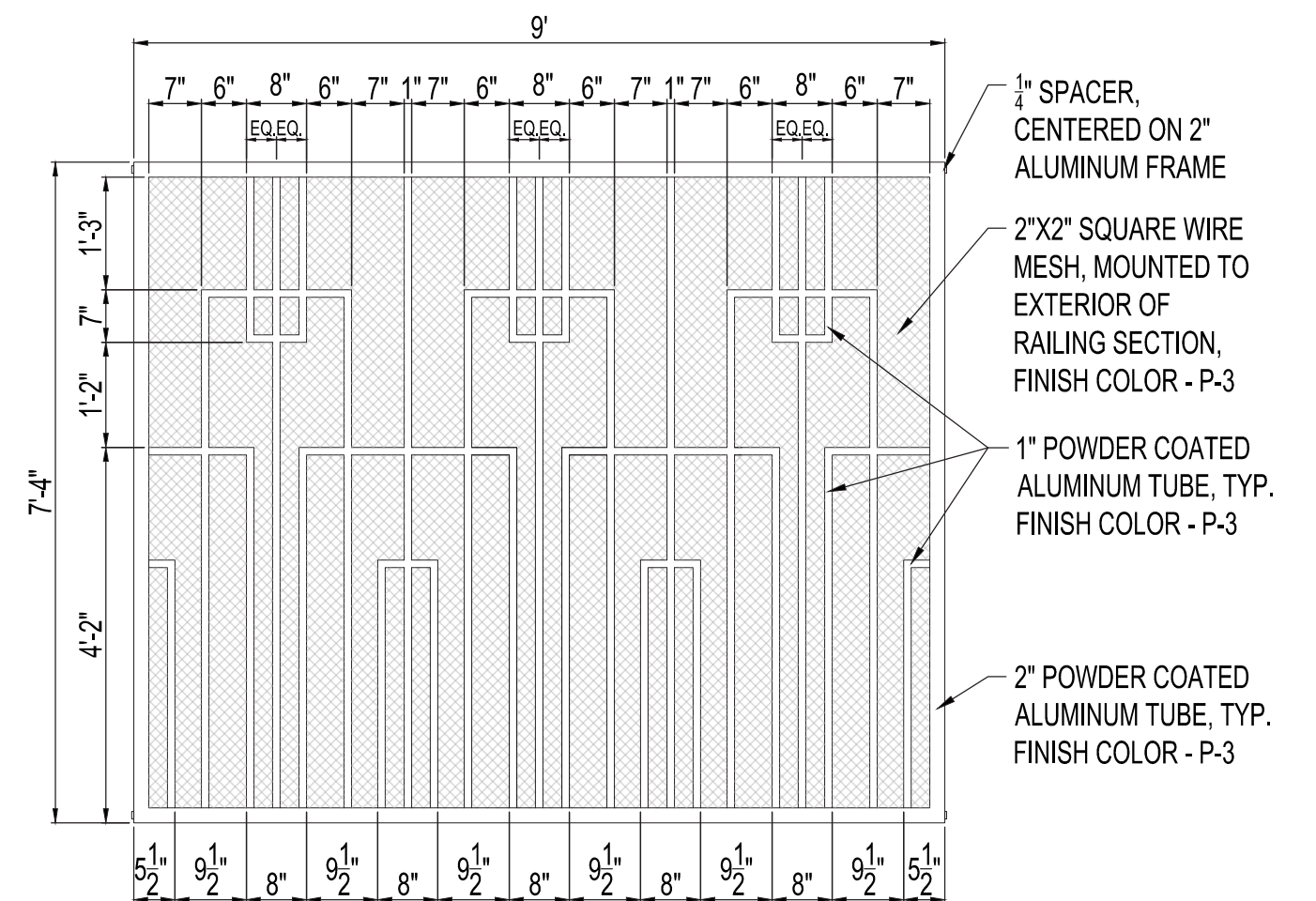

RAILING PANEL B

SCALE: 1/2" = 1'

POST AND RAILING DETAILS



SINGLE POST RAIL RENDERING

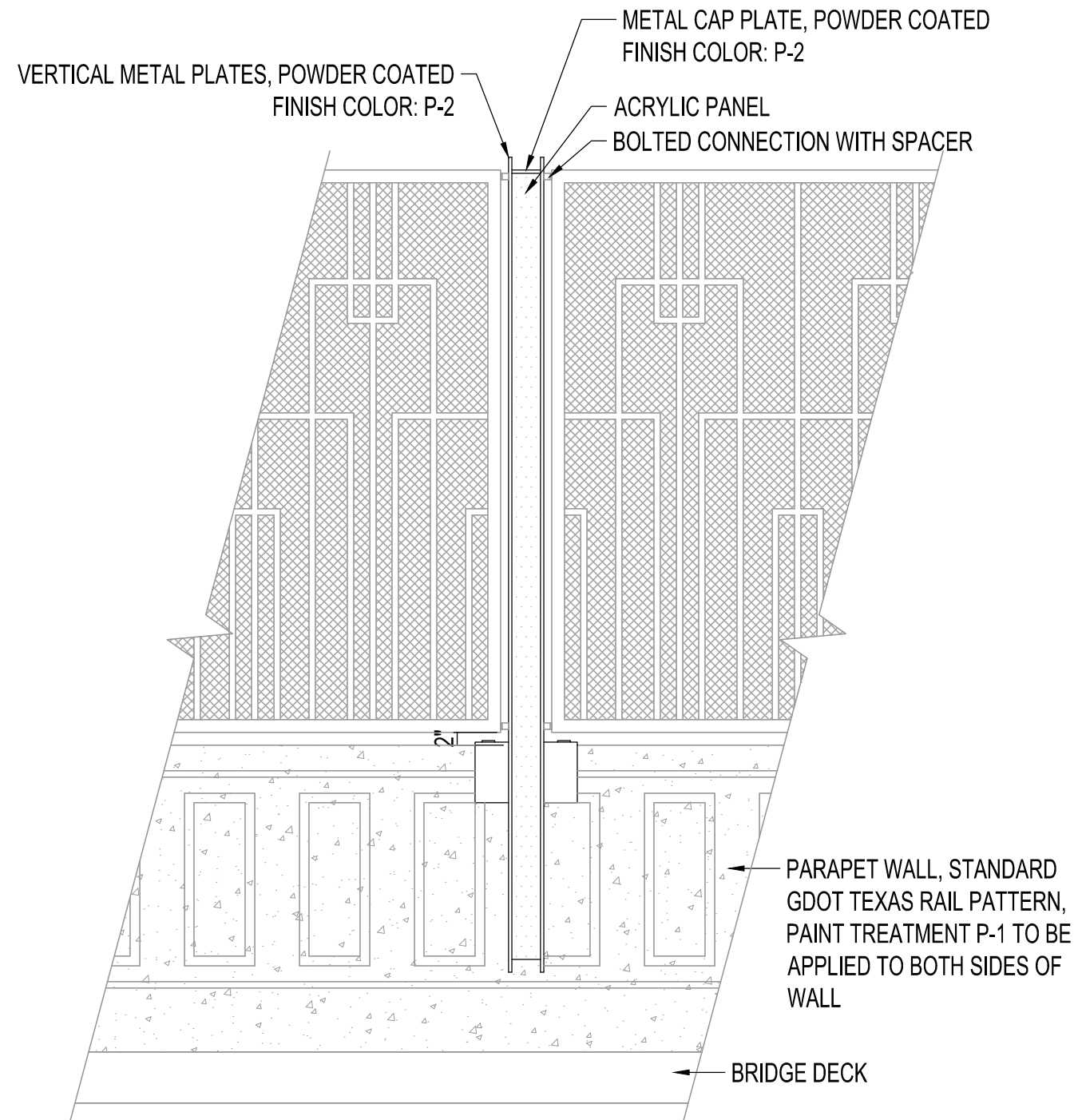

SINGLE POST RAIL ELEVATION

SCALE: 1/2" = 1'



DOUBLE POST RAIL RENDERING

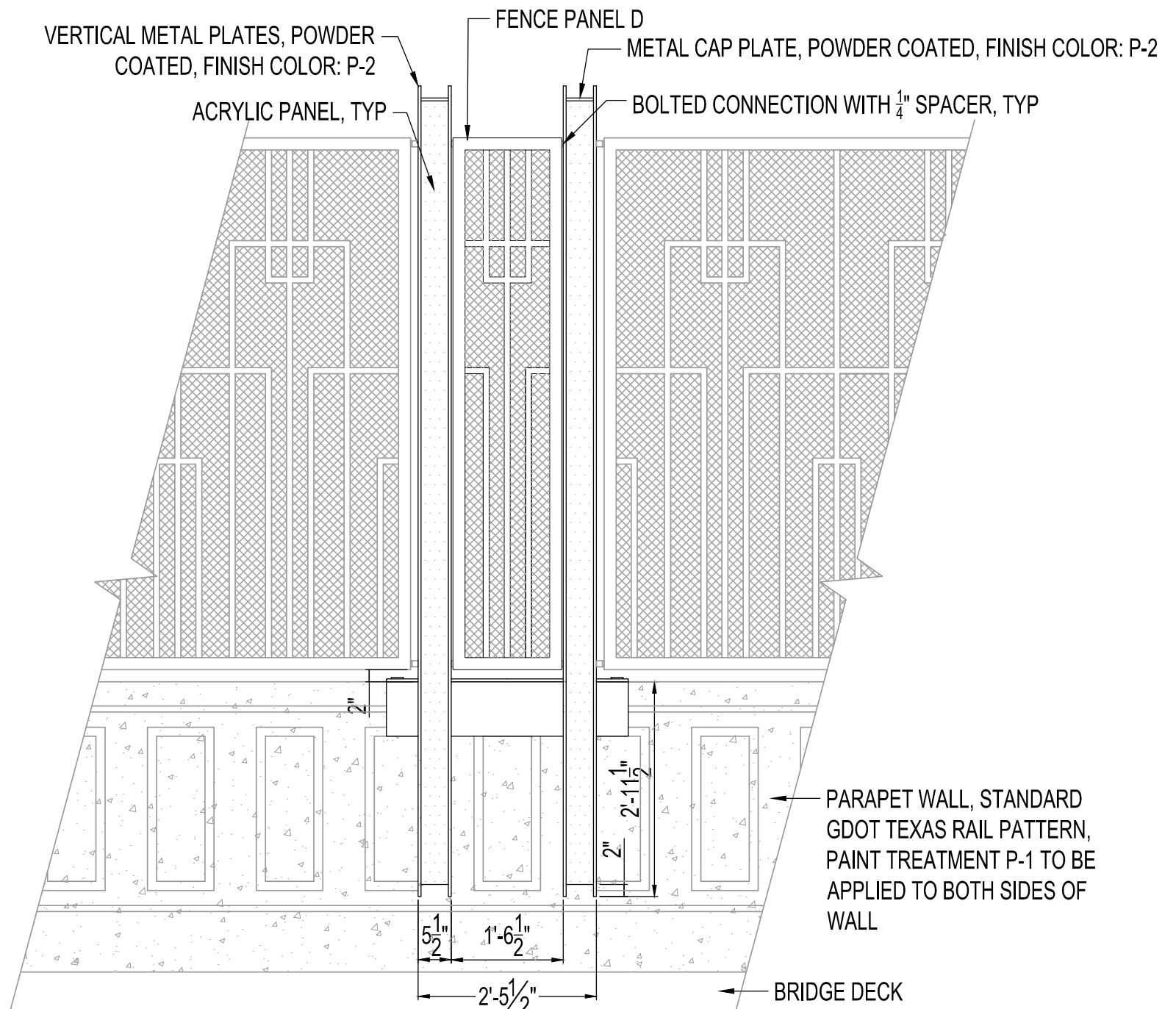

DOUBLE POST RAIL ELEVATION

SCALE: 1/2" = 1'



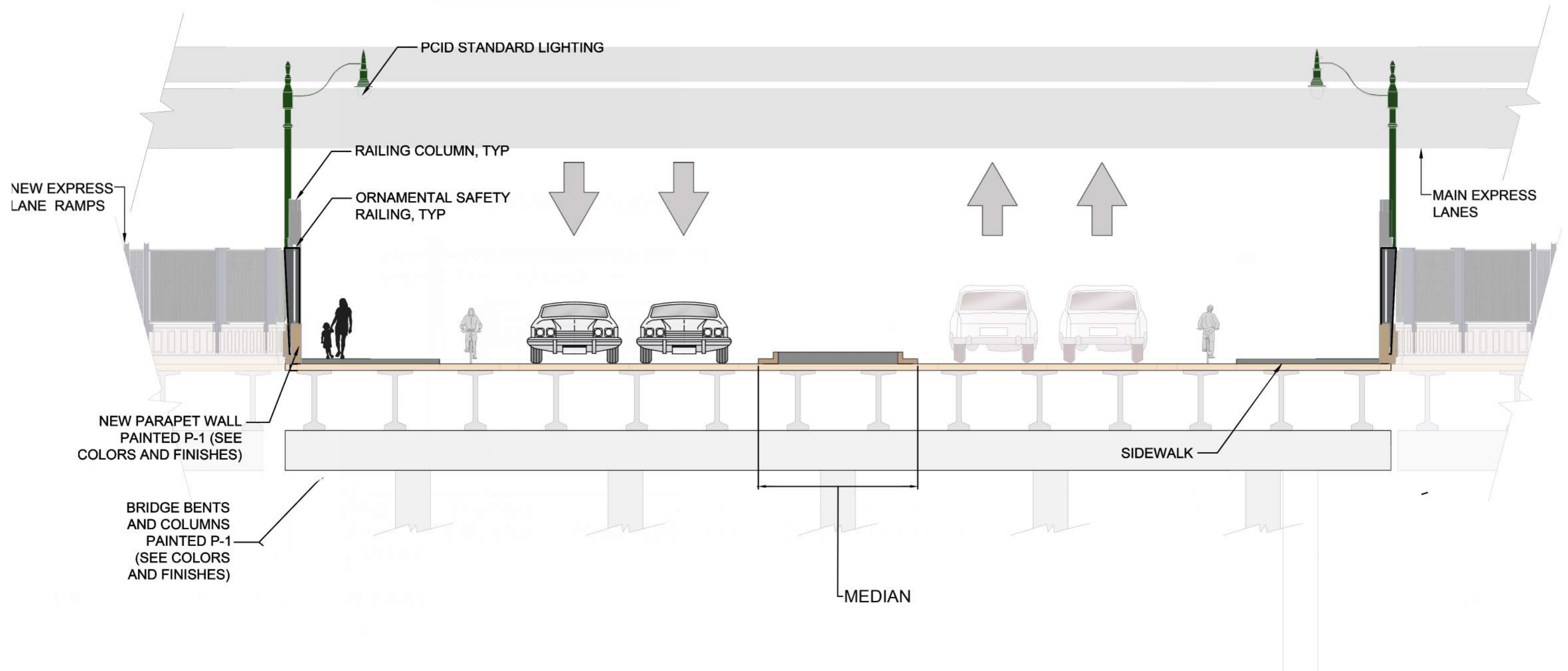

PERIMETER CENTER PARKWAY BRIDGE: SECTION AA

CROSS STREET NAME DETAIL



CROSS STREET NAME SIGN RENDERING

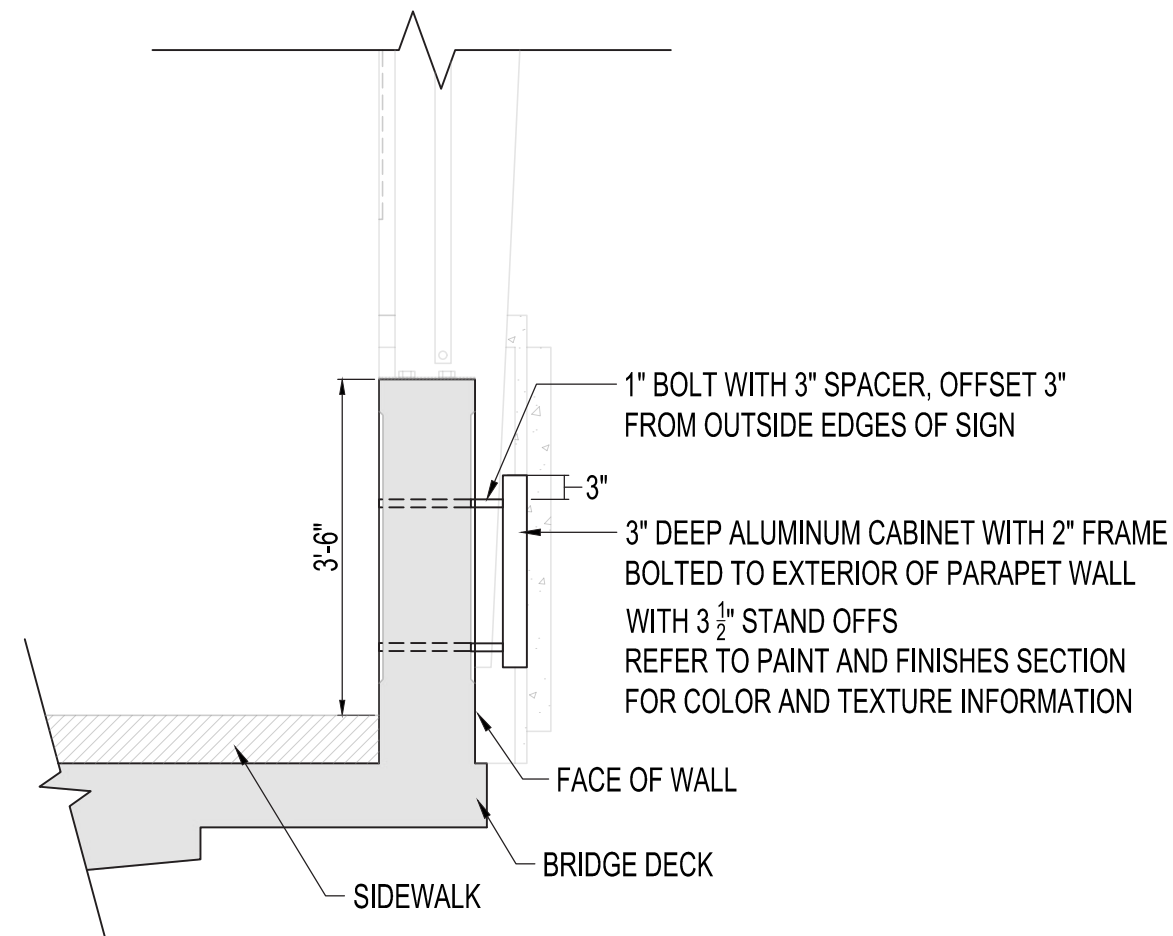

CROSS STREET NAME SIGN SECTION
SCALE: 1/2" = 1'

NOTES AND ASSUMPTIONS

- Cross street names will be bolted-in-place aluminum cabinets with dimensional lettering
- Sign cabinet spacers will provide sufficient clearance from wall to prevent conflicts with railing post locations
- Cross street names will be centered above oncoming travel lines on both sides of bridge (typ.)
- Crossroad names will be centered vertically on the face of the parapet wall
- Type style to match City of Sandy Springs branding requirements
- Letters to be P-7 Dark Blue Logo color, refer to paint and finishes

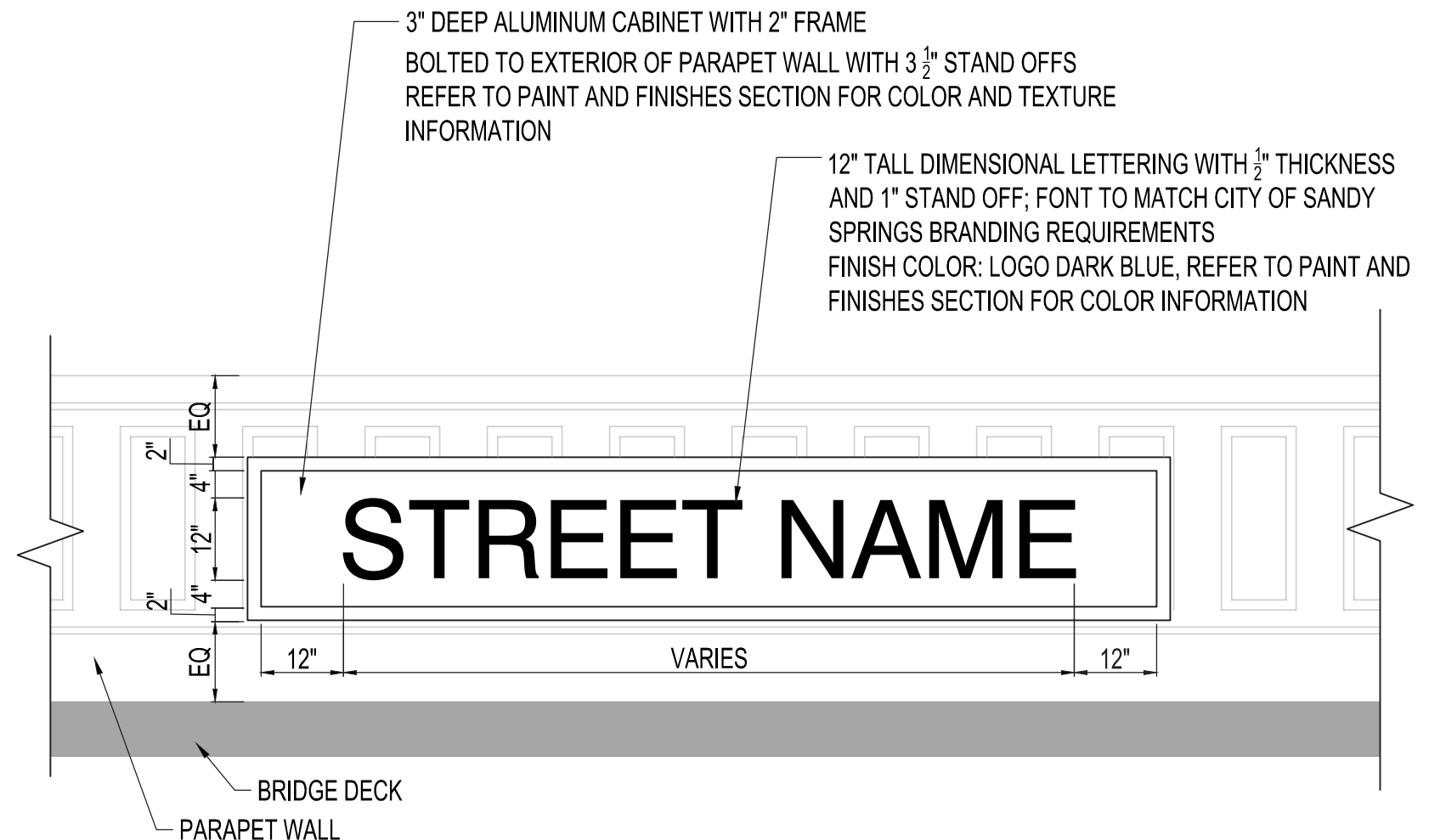

CROSS STREET NAME SIGN DETAILS
SCALE: 1/2" = 1'

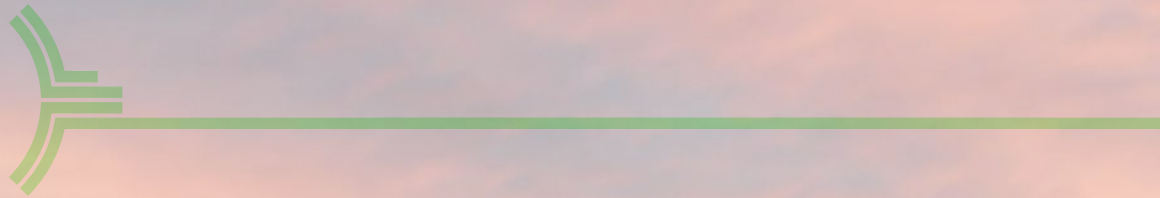

PCID Bridge Enhancements
OPINION OF PROBABLE CONSTRUCTION COST

The Consultant has no control over the cost of labor, materials, equipment, or over the Contractor's methods of determining prices or over competitive bidding or market conditions. Opinions of probable costs provided herein are based on the information known to Consultant at this time and represent only the Consultant's judgment as a design professional familiar with the construction industry. The Consultant cannot and does not guarantee that proposals, bids, or actual construction costs will not vary from its opinions of probable costs.

29-May-25			ITEM DESCRIPTION	UNITS	UNIT PRICE	QUANTITY	ESTIMATE AMOUNT	Subtotals	Total	50% Contingency/ Escalation Markup
Dunwoody MMIP										
Chamblee Dunwoody Road 325 LF	Railing System	0	Railing removal	LF	\$10.00	0	\$0	\$640,000	\$1,398,000	\$2,097,000
		0	7'6" Ornamental Fence (includes posts - \$600)	LF	\$600.00	650	\$390,000			
		0	Railing Column	EA	\$25,000.00	10	\$250,000			
		610-9099	Parapet Wall Removal	LF	\$650.00	0	\$0			
		500-2110	Concrete Parapet, Spcl design	LF	\$500.00	0	\$0			
	Lighting	0	Fence Columns Lighting	EA	\$500.00	0	\$0	\$112,000		
		0	Freestanding Ped Lights (680-4220)	EA	\$8,000.00	7	\$56,000			
		0	PCIDS Standard Bridge Light (minus cost of standard light)	EA	\$4,000.00	4	\$16,000			
		0	Electrical service and conduit to both sides of bridge	LS	\$80,000.00	1	\$40,000			
	Paint/ Finishes	0	Formliner on Parapet Walls and Structure	SF	\$0.00	0	\$0	\$544,306		
		0	Pedestrian Safety Barrier Painted single Color (20% markup)	SF	\$16.80	7040	\$118,272			
		0	Underbridge Painted single color (50% markup)	SF	\$25.00	7968	\$199,200			
		0	Parapet Wall Painted single color (20% markup)	SF	\$16.80	5312	\$89,242			
		0	Single Color Painted Columns/Bent (20% markup)	SF	\$16.80	8190	\$137,592			
		0	Single Color Painted Parapet Wall	LF	\$16.80	0	\$0			
	Bike/Pedestrian enhancements	500-2100	Concrete Barrier (pedestrian safety barrier)	LF	\$150.00	672	\$100,800	\$100,800		
		441-0106	Concrete Sidewalk, 6 in (above GDOT min.)	SY	\$75.00	0	\$0			
		0	Concrete Paver surface treatment	SF	\$17.00	0	\$0			