

To: Mayor and City Council

From: Rachel Waldron  
Parks and Recreation Director

Re: Dunwoody City Hall Permanent Façade Lighting

Date: July 28, 2025

### **Action**

Approval of contract award to Greenspeed for installation of permanent façade lighting across three rooflines of Dunwoody City Hall.

### **Summary**

“Holiday HQ” aims to increase awareness of and expand on the already successful holiday efforts across the city. Current programming includes Holiday Lights at Brook Run Park, Light Up Dunwoody sponsored by the Dunwoody Homeowners Association, activations within Ashford Lane, and more. Permanent façade lighting at Dunwoody City Hall further enhances these efforts, plus allows additional opportunities to create a sense of community throughout the year.

### **Details**

The selected lighting option includes an LED smart controller which will allow leadership to control the brightness, color, and display effects including dimming and timing. The selected lighting is sleek and minimal, making it an attractive option even when not in use. This project includes a 5-year manufacturer’s warranty on the LED lights, and a 3-year warranty on the power supply.

City staff have identified two potential funding sources for this project:

- Option 1:
  - General Capital Project Fund – Unallocated Capital (Shallowford Road Proceeds) - \$96,156.38  
(Note: Current budget available within Unallocated Capital (Shallowford Road Proceeds) is \$836,401).
- Option 2:
  - General Fund – Unassigned Fund Balance - \$96,156.38  
(Note: Unassigned fund balance within the General Fund as of 12/31/25 is currently projected to be \$28,687,988.)

Staff is seeking the feedback of Council for the recommended funding source of this project.

### **Recommendation**

Staff respectfully requests that Council: (1) Award a contract to Greenspeed for installation of permanent façade lighting across three rooflines of Dunwoody City Hall, in the amount of \$96,156.38; (2) Authorize Staff to provide funding for the contract, selected by Council from funding options provided; (3) Authorize the City Manager to execute the necessary documents.



# Dunwoody City Hall Façade Lighting

July 28, 2025



# Summary

- “Holiday HQ” aims to increase awareness of and expand on the already successful holiday efforts across the city. Current programming includes Holiday Lights at Brook Run Park, Light Up Dunwoody sponsored by the Dunwoody Homeowners Association, activations within Ashford Lane, Create Dunwoody’s Lantern Parade, Ravinia Holiday in Lights, and more.
- Permanent façade lighting at Dunwoody City Hall further enhances these efforts, plus creates additional opportunities to create a sense of community throughout the year.



# Background/Timeline

- “Holiday HQ” was discussed at the 2025 Council Retreat. *From mid-November through December, Dunwoody shines with something for everyone – from festive markets to sparkling light displays to community gatherings, theater and more...Dunwoody is the perfect place to shop, stay, dine and create holiday memories.*
- Staff across multiple departments have been working with local non-profits, property managers, and the like to pull together a comprehensive offering of holiday programming.
- Advertising scheduled to begin Q4.



# Financial Impact

- Option 1: General Capital Project Fund – Unallocated Capital (Shallowford Road Proceeds) - \$96,156.38  
(Note: Current budget available within Unallocated Capital (Shallowford Road Proceeds) is \$836,401).
- Option 2: General Fund – Unassigned Fund Balance - \$96,156.38 (Note: Unassigned fund balance within the General Fund as of 12/31/25 is currently projected to be \$28,687,988.)

# Staff Recommendation

Staff respectfully requests that Council:

1. Award a contract to Greenspeed for installation of permanent façade lighting across three rooflines of Dunwoody City Hall, in the amount of \$96,156.38;
2. Authorize Staff to provide funding for the contract, selected by Council from funding options provided;
3. Authorize the City Manager to execute the necessary documents.









## PROPOSAL – DECORATIVE LIGHTING – 3 SIDES

Presentation Date 07/11/2025

City of Dunwoody – City Hall  
4800 Ashford Dunwoody Rd NE  
Dunwoody, GA 30338

## CITY HALL FAÇADE LIGHTING

# Proposal

CITY OF DUNWOODY – CITY HALL

EXHIBIT 1

LIGHTING	Price
Decorative LED RGBW Fixtures	\$24,307.69
Installation Material	\$18,537.50
Labor	\$44,338.89
Equipment	\$8,972.30
<b>Total Project , including sales tax:</b>	<b>\$96,156.38</b>



**greenspeed**  
A CHARGE ENTERPRISES COMPANY

**NOTES:**

This proposal includes holiday LED RGBW façade lighting and controls for three sides of City Hall.

This option is for controllable decorative lighting and is not capable of completely lighting the front of the building down to the ground.



## Project Details

1. Proposal includes all material, sales tax, labor, project management, full-time on-site supervision, commissioning, permit and equipment for a complete turnkey installation.
2. Proposal includes LED RGBW decorative lighting on the building façade for the front of City Hall and the two sides. The back of the building is excluded.
3. Installation duration is three weeks from start of installation to closeout.
4. Greenspeed will run a continuous circuit along the roof parapet wall to provide power to the LED fixtures.
5. City of Dunwoody to provide electrical circuit to the roof connected to the building's existing electrical infrastructure.
6. Greenspeed anticipates no roof penetrations during installation.





## CONTACT US

3295 River Exchange Drive. Ste 405

Peachtree Corners, GA 30092

+1 (678) 793-4752

[phughes@greenspeed.com](mailto:phughes@greenspeed.com)

PROJECT:		PREPARED BY:	
PART #		QTY:	
NOTES:		DATE:	

## GL Series Installation Guide



## GL Series Installation Guide

The GL Series with LED nodes consists of:

1. Control box. Includes Controller and 150W-12V Power supply. (1) Note. cable entry from bottom of box.
2. PSU box. Includes 150W-12V Power supply. (as many as you need. 1 every 15m or 50' to inject 12vdc)
3. LED Nodes. These are supplied in a string, of 5, 2 or 1. They have IP67 male and female connectors (tighten by hand)
4. Mounting channel (Aluminium, in the required finish. White, beige and brown are std. other colors available at extra charge. will need to supply RAL #.
5. Cabling. T-Connectors (for injecting power) Jumper cables, 20/10/5/3/1' lengths

Note: Residential generally has Node facing down. Commercial generally has nodes facing outwards

Note: You will need to get self tapping screws to attach the channel to the facade (we use #8)

### Method for installation:

1. This controller can be connected to your mobile device via blue tooth (30' line of site rule of thumb, works much longer distances tho normally. Or via WIFI. Wifi being the most common. It is easier to connect controller to the device when in close proximity, so we generally have clients down load the app (gouly lighting) and set it up. will require email address or phone number. The app will go thru the steps. When 1st turned on, the nodes will appear blue which means they have no signal. There is a settings button on the app, the IC for these is IC2904.
2. Plug the control box in (it will be pre wired to the controller) and reset the controller and the wifi (there is a pin included) and attach a string of led to the controller. You will be able to see whats going on. The app will have instructions on how to connect to the wifi. Once connected, turn off, and Place the control box to its desired placement.
3. Determine the location of the Control box. (Generally on the left or right, led nodes will feed away from the control box. There are arrows on the nodes, plus they are sexed. They can only be fitted one way. Will need a Power source to feed 110vac to the Control box. 20' is about the max distance to the 1st Node. (this is for signal and voltage drop)
4. Calculate # of extrusions you will need per run. They are 1M (3.28' long) Std LED string is 5 nodes or 1M. The extrusion will almost certainly need to be cut. Use a fine toothed blade, and cut slowly to prevent catching.
5. Make a diagram and note parts used.
6. Figure out how long a lead in (jumper) cable you need, attach to the 1st LED node in the string. Can attach to the control box later.
7. Fit the LED nodes into the extrusion (snap into place, can be removed easily with small flat head screw driver) Pay attention to which end of the channel extrusion you fit them to.
8. If you have more than 15M (50') will need to inject 12V power via T-con connector. This is fed from the PSU box. Will need to add an extension cable to the t-con (only have 6" tails) We crimp and secure with dual skin heatshrink with glue. The bare end of the tail is connected to the DC side of the PSU.
9. It is always a good idea to feed 12v power at the end of the line too.
10. Once all connected and checked, check all connections, turn power on. Make sure all the PSUs are turned on at the same time. if the LEDs come on in blue, this means they have no signal. You will need to count the LED nodes, this # will need to be put into the settings. The app has many scenes, some start from the ends, middle etc.. so if the count is wrong it will not look correct.
11. The end connector, or open connector on the t-con, we put water proof heat shrink on.
12. We have youtube videos on how to use app.



## GL Series Installation Guide

### Controller



### Nema Enclosure



## 12V Power Supply



### ■ Features

- AC input range selectable by switch
- Withstand 300VAC surge input for 5 second
- No load power consumption<0.5W
- Miniature size and 1U low profile
- High operating temperature up to 70°C
- Protections: Short circuit / Overload / Over voltage / Over temperature
- Cooling by free air convection
- Compliance to IEC/EN 60335-1(PD3) and IEC/EN61558-1, 2-16 for household appliances
- Operating altitude up to 5000 meters
- Withstand 5G vibration test
- High efficiency, long life and high reliability
- LED indicator for power on
- 100% full load burn-in test
- 3 years warranty

### ■ Applications

- Industrial automation machinery
- Industrial control system
- Mechanical and electrical equipment
- Electronic instruments, equipments or apparatus
- Household appliances

### ■ Description

LRS-150 series is a 150W single-output enclosed type power supply with 30mm of low profile design. Adopting the input of 115VAC or 230VAC(selectable by switch), the entire series provides an output voltage line of 12V, 15V, 24V, 36V and 48V.

In addition to the high efficiency up to 90%, the design of metallic mesh case enhances the heat dissipation of LRS-150 that the whole series operates from -30°C through 70°C under air convection without a fan. Delivering an extremely low no load power consumption (less than 0.5W), it allows the end system to easily meet the worldwide energy requirement. LRS-150 has the complete protection functions and 5G anti-vibration capability; it is complied with the international safety regulations such as TUV EN60950-1, EN60335-1, EN61558-1/-2-16, UL60950-1 and GB4943. LRS-150 series serves as a high price-to-performance power supply solution for various industrial applications.

### ■ Model Encoding

**LRS - 150 - 12**

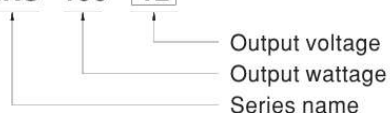

## GL Series Installation Guide

### LED Nodes



### GLMD176-RGBW

LED Quantity: 3pcs SMD5050  
Power: 0.96W  
IC type: UCS2904  
Size(mm): 42\*32\*15.5MM  
Size of mounting hole:  $\Phi 30$ MM

Voltage(v): DC12V  
IP Rank: IP68  
Color: RGBW Chasing light  
Notes: 1 / 5 / 10 pcs/String

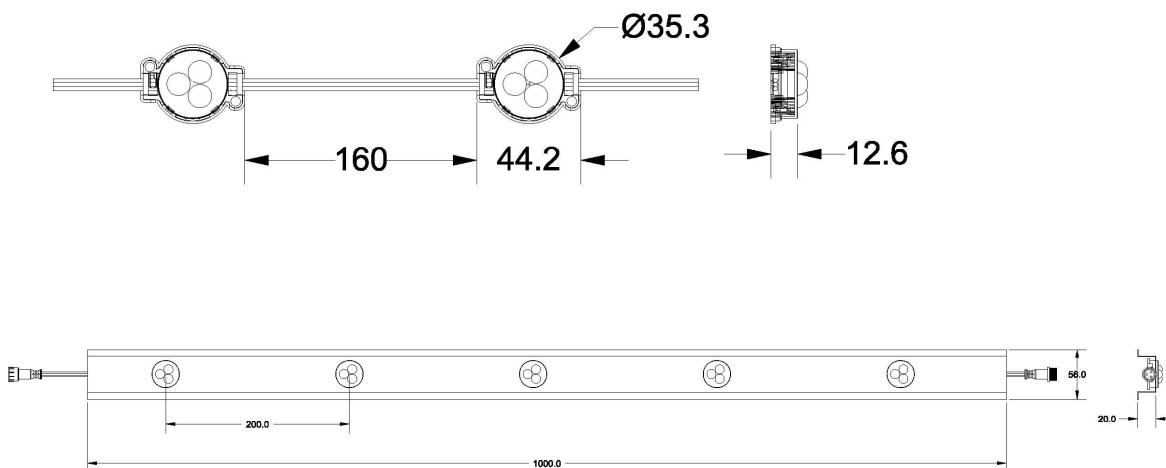

### BASIC WIRING DIAGRAM



1ft connector



2ft connector



5ft connector



10ft connector



20ft connector



T connector with DC



T connector with  
two naked wires



two output



## GL Series Installation Guide

### Mounting Channel (Extrusion)

#### Customizable colors

typology: Single side point light source aluminum

Double side point light source aluminum

Raised shape point light source aluminum

Single side with buckle

Dedicated bridge rope

Cove lighting

Thickness: 0.6-1.2mm Customizable thickness

Size: Various sizes available Customizable sizes

Hole size: 20/30/40/50mm



Nodes snap into underside of the channel

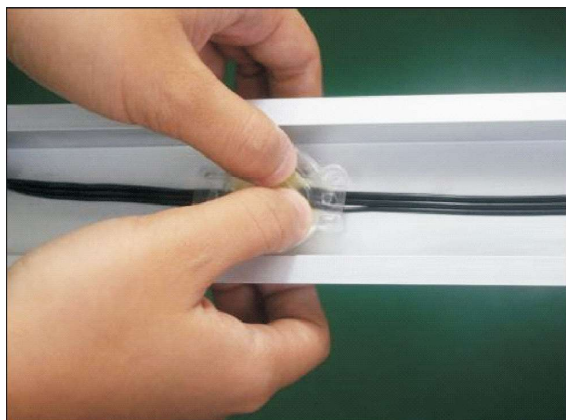

## GL Series Installation Guide

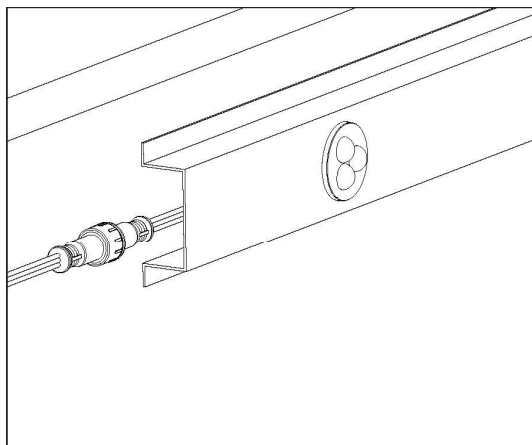

Channel cutting / Mounting

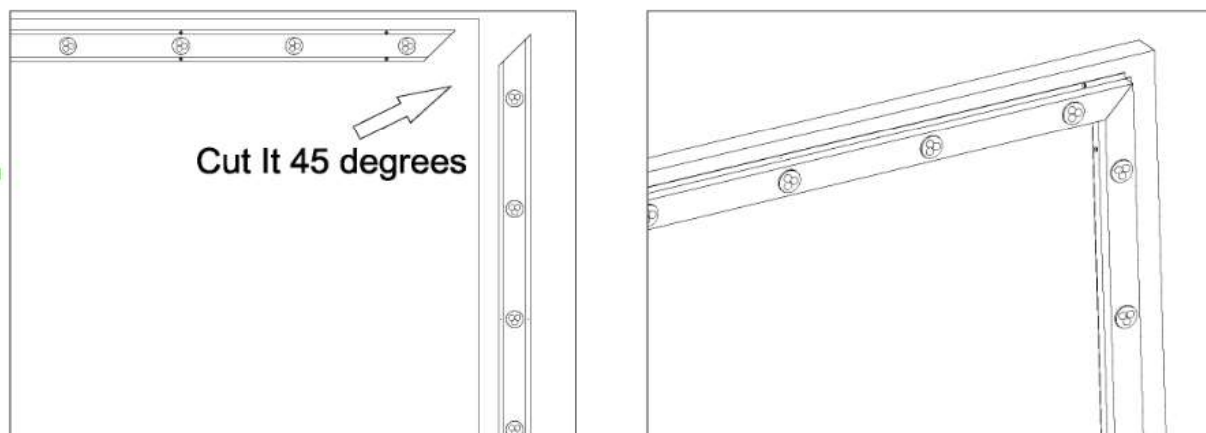
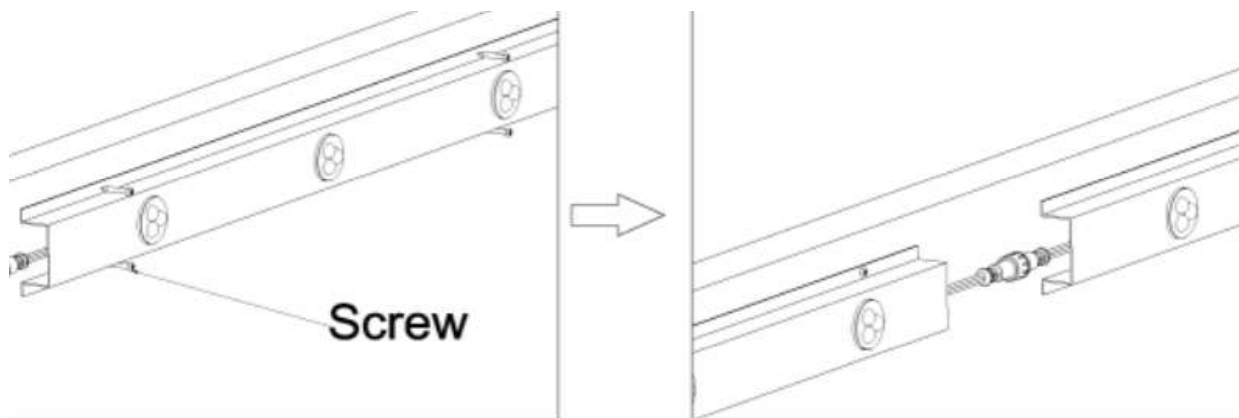

PROJECT:		PREPARED BY:	
PART #		QTY:	
NOTES:		DATE:	

GL Series Installation Guide

BASIC WIRING DIAGRAM

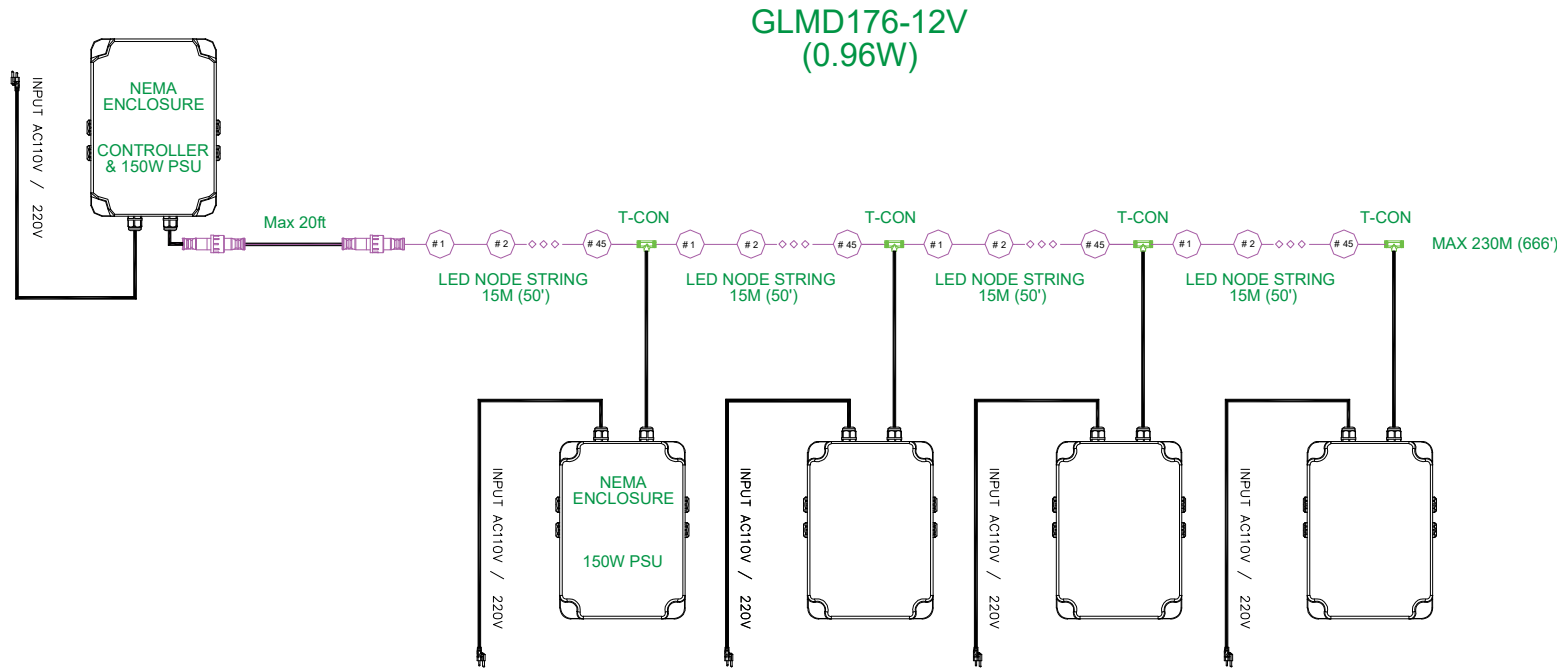



## Warning

1. Before turning on the power, please make sure all connections are correct and safe, do not operate it when it is turned on.
2. The product should be used under rated voltage, using it under excessive or insufficient voltage may cause damages
3. Please do not disassemble the product to avoid fire and electric shock.
4. Do not use this product around metal shielded areas or strong magnetic fields, as this may seriously affect the wireless signal transmission of this product.

## Disclaimer

1. We will update the contents of this manual according to the improvement of the product functions, and the updated contents will be shown in the latest version of this manual without further notice.
2. Due to our continuous adoption of new technologies, product specifications are subject to change without prior notice.
3. This manual is for reference and guidance only, and does not guarantee that it is identical with the actual product, the actual application should be based on the actual product.
4. The components and accessories described in this manual do not represent the standard configuration of the product, the specific configuration of the package shall prevail.
5. All text, tables and images in this manual are protected by relevant national laws and may not be used without the permission of the Company.
6. This product may be compatible with third-party products (e.g., applications, hubs, etc.), but the Company is not responsible for compatibility issues or partial loss of functionality caused by changes in third-party products.

## Quality Assurance of LED light (Manufacturer)

The warranty period is five years. Within the warranty period, if any product breaks down or is damaged under proper use as per the instruction manual, the customer should provide us with videos or pictures of the broken/damaged product. We will then offer a free replacement.

The warranty period starts from the date of manufacture. In case of special circumstances, the customer and the manufacturer may negotiate accordingly.

Even within the warranty period, if any of the following situations occur, a certain replacement fee will be charged.

Malfunctions or damages caused by incorrect use, unauthorized repairs, or alterations.

Damage caused by fire, flood, abnormal voltage, other natural disasters, or secondary product damage.

Product malfunctions caused by operation not in accordance with the user manual.

Malfunctions or damages caused by other obstacles, including man-made factors or external devices.

For any after-sales service issues, please contact us directly.

After service Department

Date: 3<sup>th</sup> Jul, 2025

